

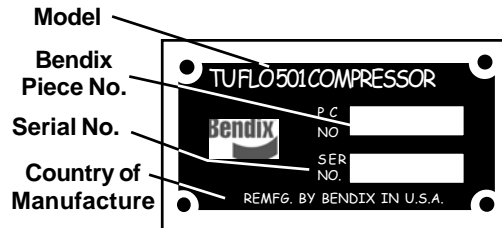

BENDIX COMPRESSORS AND PARTS



**REMANUFACTURED EXCHANGE
COMPRESSORS**



Compressor Nameplates

A nameplate is attached to all compressors. It displays the model, piece number and serial number. A nameplate with a black background denotes a new original equipment compressor, whereas a nameplate with a red background designates that the compressor is a Bendix remanufactured/replacement unit. When making reference to a particular compressor, use the pc. no. stamped on the nameplate.

**Tu-Flo® 550 & Tu-Flo® 750
most popular configurations**
Unless indicated, inlet and discharge locations are as shown.

Compressor Port Orientation
Right
Left



Tu-Flo® 550 for CAT
Part No. 5002984x
3406, C10, C12, C15, C16
(rear end cover studs)
Part No. 5005790X
3176, C15, C16

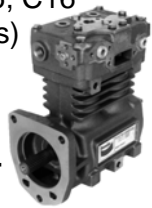

Tu-Flo® 550 for CAT
3116, 3126, C7 Acert, C9 Acert
Top Inlet unless noted,
removable rear flange cover
Part No. 5011016X
Part No. 107981X
(left inlet)



Tu-Flo® 750 for CAT
Part No. 5002713X
3406, C10, C12, C15, C16
(rear end cover studs)
Part No. 5002983X
3176, C15, C16



Tu-Flo® 750 for CAT
Part No. 5004118X

Tu-Flo® 550 for CAT
3176 (flange mount)
Part No. 109603X

**Tu-Flo® 550 for
CAT 3306**
Part No. 109251X



**Tu-Flo® 750 for
CAT 3306**
Part No. 109287X

Tu-Flo® 550 for CUMMINS
Part No. 108804X
ISB & C (top air inlet)



**Tu-Flo® 550 for
CUMMINS ISM,
N14, M11**
Part No. 107506X

Part No. 5005790X
(left air inlet)



Tu-Flo® 750 for CUMMINS
Part No. 109382X
ISB & C
(top air inlet)

**Tu-Flo® 750 for
CUMMINS ISM,
N14, M11**
Part No. 107507X

**Air Compressor
Discharge hose fitting**
Part No. 142110

Designed for use with stainless steel braided discharge hose. All brass bodies with brass sleeves and steel nuts. 5/8" OD.



Hose Part No. 919-10



**Air Compressor Discharge
Hose Assembly**
Part No. 142552

Length = 52 inches
Hose I.D. = 1/2 inch
Hose O.D. = 5/8 inch
Part No. 142572 (72 inches)



BENDIX COMPRESSORS AND PARTS

WHY A BENDIX REMANUFACTURED COMPRESSOR?

- All components are inspected and then replaced or remanufactured to the highest Bendix OEM manufacturing and product specifications, long the industry standard.
- All Bendix remanufactured compressors meet or exceed OE manufacturing functional, end-of-line test specifications.
- Bendix discards and replaces all wear components – o-rings, gaskets, piston rings, bearing inserts, sleeve bearings, unloader springs, seals, studs, lock washers, pipe fittings, inlet and discharge valves, inlet and discharge springs, wrist pin plugs and safety valves – with new components in all remanufactured compressors.
- During the remanufacturing process, genuine Bendix compressors are upgraded with the latest manufacturing methods, technologies and product enhancements, often making our remanufactured product better than the original.
- These upgrades are done even if the replaced compressor did not have the enhancement when new.



Look for our Governors on page 8!

	<p>Tu-Flo® 550 for Detroit Diesel Series 60 non-EGR (69 tooth gear w/21 tooth spline) Part No. 5004188X</p>	
	<p>Tu-Flo® 750 for Detroit Diesel 3306 Series 60 non-EGR & Series 50 (69 tooth gear w/21 tooth spline) Part No. 5004187X</p>	
<p>Tu-Flo® 550 for International V8 pre-2004, T444E Part No. 107514X</p>	 <p>NPT Ports</p>	<p>Tu-Flo® 550 for International I-6 pre-2004 DT466, HT530 Part No. 5004613X</p>
	<p>Tu-Flo® 550 for Mack Extended (Pre-1997)(*Head contoured for special clearance application.) Part No. *108866X Part No. 5002865X</p>	 <p>NPT Ports</p>
	<p>Tu-Flo® 750 for Mack Extended (Pre-1997)(*Head contoured for special clearance application.) Part No. *108869X Part No. 5002868X</p>	<p>Tu-Flo® 550 for Volvo Part No. 108937X</p>
		

UNLOADER KIT

Kit contains parts to install 3 piece unloader plungers in Tu-Flo compressors.
Part No. 279615N

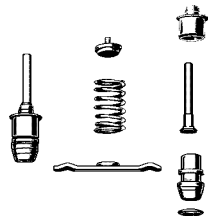

AIR STRAINER

For TF-400, 500, 501, 600, and 700 Bendix compressors
Part No. 278500N
Contents:----->

(Air Filter=Part No. PA1704)

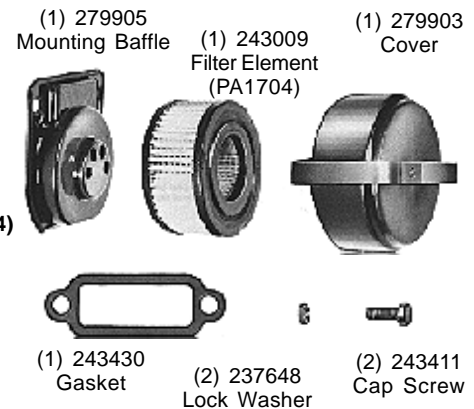

ST-4™ Safety Valve
Part No. 131081
250 psi.





HALDEX COMPRESSORS AND PARTS

REMANUFACTURED HALDEX COMPRESSORS

Head Assembly

Rotate to match your inlet/outlet port needs; extra gasket included!

Unloader Assembly

Thru-the-head servicing. Quick and easy way to restore to original performance!

Connecting Rod and Bearings

Robust design provides extended service life and eliminates connecting rod failures!



Cylinder Block

Water cooled to provide maximum life and performance.

Piston & Ring Assembly

Perfect balance of function and service life. Minimizes oil passing and life ending early failures due to piston and cylinder wear.

Main Bearing

Ball bearings ensure trouble-free life and smooth operation.

Part No. 3558052X

Cubic Feet Per Minute: 13.2

Model: QE296C Quiet Economy Single Cylinder

Air Inlet: Left **Air Outlet:** Front **Spline:** 11 Tooth

Application/Notes:

Cummins C Engine.
Iron Head/Cover.
Intake Valve Retainer.
Thru-Drive for power steering pump.
Flange Mount, Engine Drive, Water Cooled, Threaded Discharge Type.



Holset

Part No. 3018543X

Cubic Feet Per Minute: 13.2

Model: SS296 Super Single Cylinder

Air Inlet: Left **Air Outlet:** Rear

Unloader Port Type: Left/Direct

Application/Notes:

For L/K/N engines.
Flange Mount, Engine Drive, Water Cooled.



Holset

Part No. 3558072X

Cubic Feet Per Minute: 13.2

Model: QE296 Quiet Economy Single Cylinder

Air Inlet: Left **Air Outlet:** Rear **Spline:** 11 Tooth

Application/Notes:

Cummins L10/N14. Iron Head/Cover.
Intake Valve Retainer. Flange Mount, Engine Drive, Water Cooled, Threaded Discharge Type.



Holset

Part No. EL13020X

Rotatable Head, Belt Drive, End Cap, Oil Feed Base, Oil Drain, Water Cooled Top/Flange Discharge Type
Overall Height: 11.42 in.
Overall Width: 4.79 in.
Overall Length: 8.93 in.
External Shaft Length: 2.14 in.

Head Rotation: Right

Block Rotation: Right

Notes: High Capacity Replacement **EL16020X**



Haldex Haldex Repair Kits

RN26A EL1300 Unloader Kit
RN26GW EL 13 00 Gasket Kit
SN144 Installation Kit



Part No. EL16040X

Head Rotatable, Double Flange Mount, Gear Drive Flange Oil Feed, Side Option on Service Units, Flange or Base Oil Drain Top/Flange Discharge Type, Turbochargeable, Water Cooled
Overall Height: 12.57 in.
Overall Width: 5.68 in.
Overall Length: 9.09 in.

External Shaft Length: .54 in.

Head Rotation: Right

Block Rotation: Right

Notes: High Capacity.

Application: Cummins In-Line Engines



Part No. EL16111X

Flange Mount, Gear Drive, Cranshaft End, Oil Feed Flange, Oil Drain, Water Cooled Top/Threaded Discharge Type
Overall Height: 12.19 in.
Overall Width: 5.43 in.
Overall Length: 11.58 in.
External Shaft Length: .16 in.

Head Rotation: Left

Block Rotation: Left

Notes: High Capacity



Haldex Haldex Repair Kits

RNT26A EL1600 Unloader Kit
RN26GZ EL 1600 Gasket Kit
SN144J Installation Kit

COMPRESSOR MANIFOLD KIT

(INTAKE) For 1/2" Pipe.
Mounting Centers: 2.75"
Part No. SN3711AA



COMPRESSOR MANIFOLD KIT

(INTAKE) For 3/4" Hose
Mounting Centers: 2.75"
Part No. SN3711AD



AIR CLEANER / FILTER

Part No. KN19040 (Air Filter=Part No. PA2256)

Provides greater atmospheric air intake capacity. May be remote mounted by using kits SN3711AC/ SN3711AD and cut to length 3/4" ID hose with fittings and clamps. -Includes 100696E element. Mt. Centers=2.75", Height=4.44" Dia.=4.30"

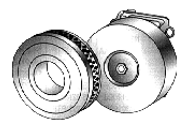



BENDIX AIR DRYERS

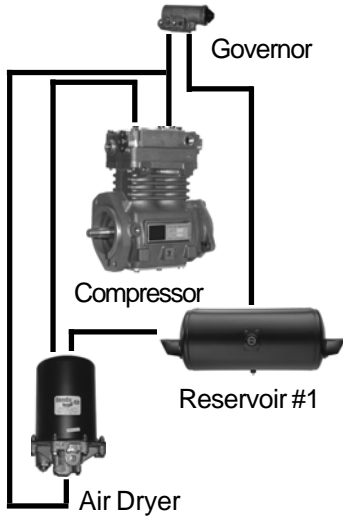

The primary duty of the air dryer

is to eliminate the moisture and dirt that would cause damage to valves and other system components. The air dryer removes these pollutants, providing dry air, free of contaminants that can cause premature failure of the air and brake system.

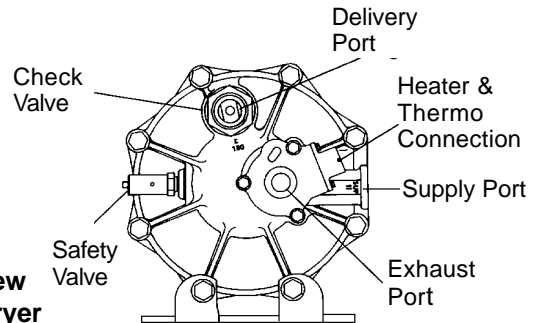

End Cover Bottom View AD-9 Air Dryer

Bendix AD-9® Air Dryer 12 Volt	
Description	PART No.
Complete New Unit	065225
Complete REMAN Unit	109685X
AD-9 DROP IN	065647
END COVER INFORMATION	
New Unit: (Special Order)	065231
Supply Port:	1/2" P. T.
Delivery Port:	1/2" P. T.
Control Port:	1/4" P. T.
Check Valve Ass'y - 1/2"	107800N
Purge Valve & Heater Ass'y (REMAN)	5004341X
Reman Desiccant Cartridge	107794X
Purge Valve Ass'y - Maint. Kit	5005037
Bracket Kit	107695

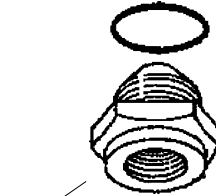

Bendix AD-IS® Air Dryer Spin on Cartridge, DRM™ model	
Description	PART No.
New Unit	800383
Bendix AD-IS® Air Dryer Spin on Cartridge	
New Unit	801266
REMAN Unit	5010696X
KITS AND SERVICE PARTS	
Desiccant Cartridge Kit	5008414
Governor and Check Valve Kit	5004049
Heater and Thermostat kit (12v)	109495
Purge Valve Maintenance kit	5003547
Purge Valve replacement kit	K022105
Wiring Harness and Splice kit	109871N

(Can not sub other governors)

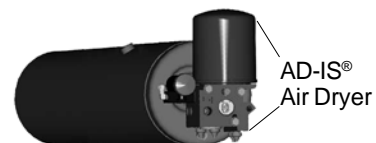
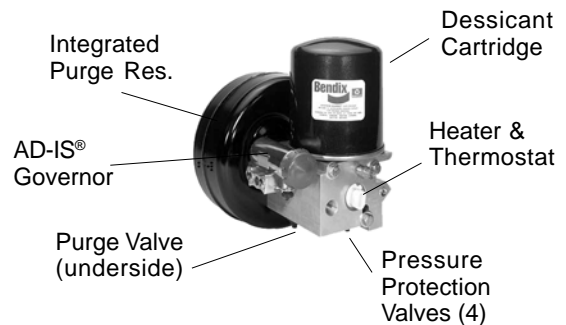



BENDIX AD-9™ AIR DRYER

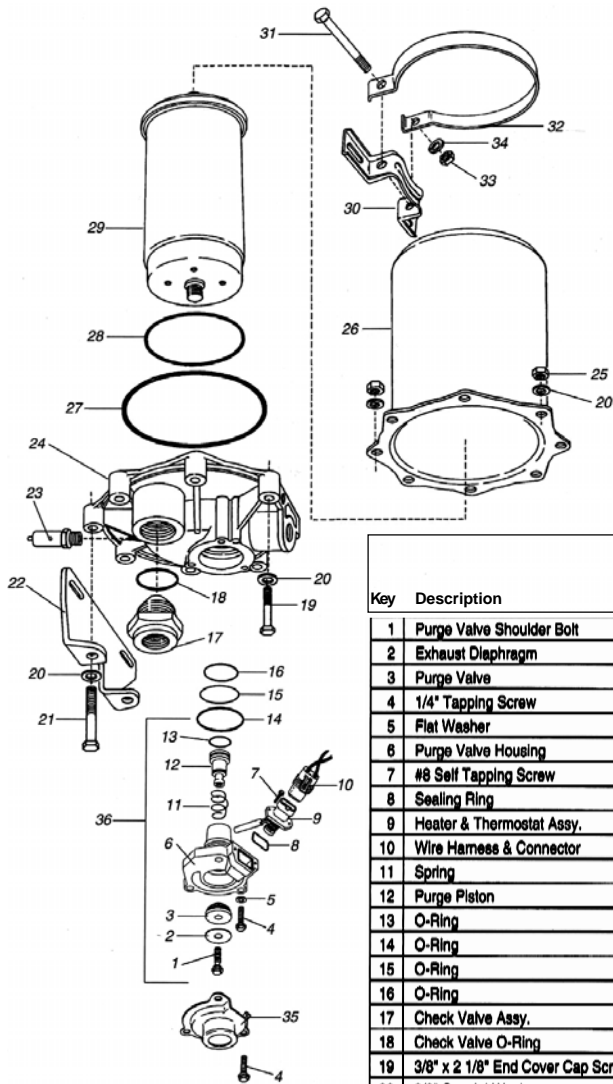

Part No. 107794X
Desiccant Cartridge Kit



Part No. 5004341X
AD9 12V Purge Valve Kit



AD-9 Air Dryer Parts Kit List

Key	Description	New Purge Valve w/ heater 800405 -12v 109570 -24v	Reman Purge Valve w/ heater 5004341X -12v 5004342X- 24v	New Purge DLU Valve w/ heater 109580 -12v 109599 -24v	Des. Cart kit 107796 -new 107794X-reman	Purge Vlv & Therm kit Maint. Kit 109578 -12v 109579 -24v	Heater-note 1 & Therm kit 109578 -12v 109579 -24v	Check Valve Kit 107799 -3/4" 107800 -1/2"	Mnting Brkt kit 107695
1	Purge Valve Shoulder Bolt					X			
2	Exhaust Diaphragm					X			
3	Purge Valve					X			
4	1/4" Tapping Screw	X-3	X-3	X-3		X-3			
5	Flat Washer	X-3	X-3	X-3					
6	Purge Valve Housing								
7	#8 Self Tapping Screw						X-2		
8	Sealing Ring						X		
9	Heater & Thermostat Assy.						X		
10	Wire Harness & Connector				109869N				
11	Spring					X			
12	Purge Piston								
13	O-Ring					X			
14	O-Ring	X	X	X		X	X		
15	O-Ring	X	X	X		X	X		
16	O-Ring	X	X	X		X	X		
17	Check Valve Assy.							X	
18	Check Valve O-Ring							X	
19	3/8" x 2 1/8" End Cover Cap Screw								
20	3/8" Special Washer								X-4
21	3/8" x 2 3/8" Bracket Cap Screw								X-2
22	Lower Mounting Bracket								X
23	Safety Valve				285849				
24	End Cover								
25	Lock Nut								X-2
26	Housing								
27	O-Ring				X				
28	O-Ring				X				
29	Desiccant Cartridge Assy.				X				
30	Upper Mounting Brkt.								X
31	5/16" x 4 1/2" Upper Brkt. Bolt								X
32	Upper Brkt. Strap								X
33	5/16" Nut								X
34	5/16" Lock Washer								X
35	Exhaust Cover (See Note 2)				112399				
36	Complete Purge Valve Assy.	X	X	X					

Note:
Old and new purge valve assemblies are interchangeable in all AD-9 air dryers.



GENERAL: All kits and replacement parts and assemblies can be used in any version of the AD-9 unless otherwise noted.

Note 1: These heater and thermostat kits are for use in the new replacement purge valve assemblies and can not be installed in the old configuration purge valve assembly.

Note 2: The service AD-9 Air Dryers listed are not supplied with an extended exhaust cover, however the extended exhaust cover Pc No. 112399 can be installed on any new purge valve assemblies to allow the connection of a hose to direct expelled contaminants, away from the vehicle. This exhaust cover is available as a separate item.





BENDIX AIR DRYERS

**BENDIX REPAIR KITS
for AD-2 AIR DRYER**

- 102657N Thermostat Kit**
Includes Thermostat, gasket and "O" ring.
- 287053N Purge Valve Replacement Kit**
Includes purge valve, diaphragm, boot and "O" rings
- 101900X Desiccant cartridge**
- 286875RX End cover assy. -12v.**
- 286876RX End cover assy.-24v.**

AD-2 - Desiccant type
Reman. 12 volt,
1/2" port.
Part No. 286934RX



**BENDIX REPAIR KITS
AD-4 AIR DRYER**

- 104358X Dessicant Cartridge Kit**
- 103818 Purge Valve Replacement Kit**
Purge valve and exhaust diaphragm
- 103980N End Cover Kit**
"O" ring and piston spring

AD-4 - Desiccant type
12 volt, Reman.
60 watt heater
1/2"x1/2"x1/4" ports.
Part No. 065041X

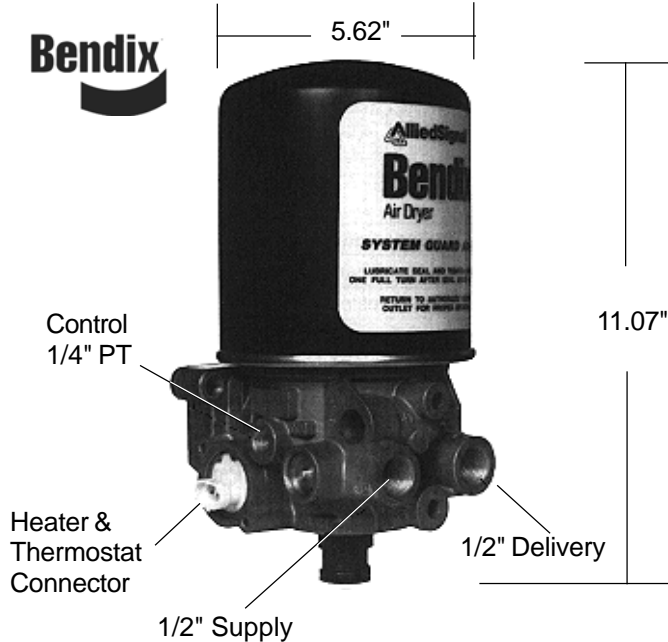

AD-SP Air Dryer System Purge		
Service Part No.	Reman. Part No.	Heater & Thermostat Volts-Watts (See Note 2)
800887	109991X	12V - 980W
065594	109992X	24V - 90W

AD-SP Air Dryer Kits	
Part No.	Description:
5008414	Cartridge Kit
5005624	Del Check Valve Kit
109995	Purge Valve Kit

Note: 12 & 24 volt AD-SP air dryers are identified by connector color: White = 12V, Gray = 24V.

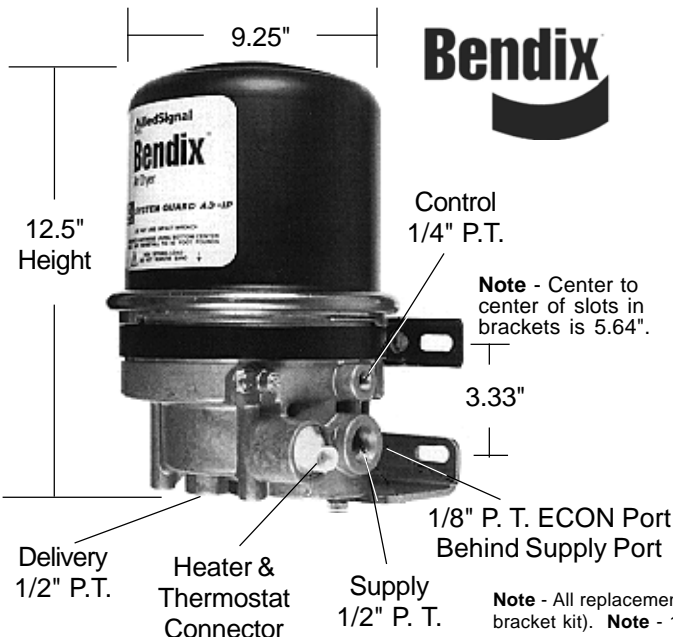

AD-IP Air Dryer Integral Purge		
Service Part No.	Reman. Part No.	Heater & Thermostat Volts-Watts (See Note 2)
065612	109477X	12V - 90W
065613	109478X	24V - 90W

AD-IP Air Dryer Kits	
Part No.	DESCRIPTION
109493X	Reman. desiccant cartridge
109494	Check valve kit
109495	12v heater kit
109498	Bolt kit
5001247	Mounting bracket kit
K022105	Purge Valve kit - High Boost

Note - All replacement air dryers include 109871 (wire harness and splice kit) and 5001247 (mounting bracket kit). Note - 12 & 24 volt air dryers are identified by connector color .White = 12V, Gray = 24V.



HALDEX AIR DRYERS & REPLACEMENT PARTS

•**DRYest™ System Purge Dryer**
Part No. DA35100 new outright
 Uses MTC desiccant cartridge for superior drying (**Part No. 47178964**), compact size, built in heater.



•**PURest™ Air Dryer**
Part No. DA34100 Outright
 •Multi-Treatment Cartridge employs 5 stages of cleaning to ensure a dry air system.
(Part No. DQ6050)
 •Universal Mounting bracket makes change overs easy.
 •Built in heater prevents freezing and damage to the dryer.



•**Pure Air Plus™ • "Like-Nu"**
Part No. DA33100X Exchange.
 With spin on desiccant cartridge. Coalescing filter for exceptional oil and contaminant removal. 12V.
DA33110X = 24V.
Desiccant Kit; Part No. DQ6026
 Includes desiccant cartridge & coalescing filter.



•**Part No. M109689X** Exchange.
 Reman air dryer from Haldex with soft seat.



•**MTC Multi-Treatment Cartridge**
Part No. 47178964(DRYest™)
Part No. DQ6050 (PURest™)
5 stages - increases dryer life!
 1-Dust filter
 2-Small desiccant
 3-Medium desiccant
 4-Large desiccant
 5-Aluminum mesh

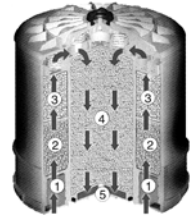

Desiccant Kit for DA33100X
Part No. DQ6026
 Includes:
 Desiccant Cartridge, Coalescing Filter, Relief Valve, Purge Shield and Associated Hardware.



Air Dryer Cartridge for AD-9
Part No. M107794X
Air Dryer Cartridge for AD-1P
Part No. M109493X



•**ConSep™ Condensor/Separator**
Part No. 41210026
 Condenses and separates oil, water, and other contaminants.
 Can be used as stand alone unit.
 Includes ADV -Automatic Drain Valve.



MERITOR AIR DRYERS & REPLACEMENT PARTS

Part No. R955205 (S4324130010)
 12V/100 Watt heater, with integral turbo cut-off valve, and mounting bracket.
 Integral regeneration valve eliminates need for purge tank.



MERITOR WABCO

SYSTEM SAVER 1200

Part No. R950011
Air Dryer Cartridge
System Saver Series



Part No. R950014
Purge Valve Kit B
Includes, O-Ring, Washer, Piston O-Ring, Piston Seat, Piston, Shims, Compression Spring, O-Ring, Valve head, and Retainer Ring.



Part No. R950015
Heater Service Kit
Includes, 2 mounting screws, wiring connector, O-ring, Wire, heater, thermostat, plastic retainer & retainer screw.



Part No. R955207
Holset Drop-In series.

SKF AIR DRYERS & REPLACEMENT PARTS

Part No. CR620502
 12V/75 Watt heater. **SKF**
 This model includes an internal valve system that provides full turbo boost protection and an internal feedback feature required for the Cummins/Holset QE and E-Type compressors.



Desiccant Cartridge Kit
 For Turbo-2000 & HD-2000 Air Dryers
Part No. CRT224



REPLACEMENT KITS: SKF
Part No. CR223 - Regeneration Valve Kit: Includes spindle, spring and o-ring
Part No. CR228 Turbo Valve Kit
Part No. CR235 Purge Valve Kit: Purge Valve, O-rings, screen.
Part No. CR619340 Kit w/Cart. Purge & Turbo.
Part No. CR223 - Check Valve Kit



FLEETCRAFT AIR DRYER AND PARTS

Fleetcraft Air Dryer

With integral turbo cut-off valve, no need for purge tank. Includes mounting bracket.

Part No. FC955205



Air Dryer Cartridge
Part No. FC950011



Fleetcraft Desiccant Cartridge Kit

For Turbo-2000 & HD-2000 Air Dryer
Part No. FCT224



ISOLATION VALVE - ALCOHOL EVAPORATOR - GOVERNORS

ISOLATION VALVE

(Turbo Cut-Off Valve)

Used with air dryers not equipped with this feature. Allows use of air dryer on turbo charged engines without affecting engine performance. Installs directly (1/2"-14 NPTF) to air line inlet port of air dryer.

Part No. KN23500

Port A: To air dryer inlet port
Port B: To pipe plug
Port C: To compressor discharge
Port D: To governor unloader
Height: 3.18"



ALCOHOL EVAPORATOR

An automatic vaporizing device for keeping air lines and air reservoir free of ice. Bracket Mount.

- Easy to install
- Pressure protected
- Holds 40 oz. of methyl alcohol.
- 1/2" NPTF Ports

Part No. A72420



FLEETCRAFT GOVERNOR

Features ball check design with filtered ports. Can be mounted at a remote location or directly to compressor. Preset to open at 120 PSI, close at 100 PSI. Can be Adjusted. Includes 4 pipe plugs, mounting gasket and instructions. New, outright.

Part No. FC18530



Bendix D-2 Governor

Remanufactured. No Core. For mounting to the compressor or mounted remotely. Pressure range 100 - 120 PSI. 5" overall height. 1/8" NPT ports. Sold outright.

Part No. OR275491X
Part No. OR284358X

(105-125 PSI, waterproof cover)
Part No. 275491N (NEW)



Part No. 236577N
Governor Gasket



Haldex Piston-Type Governor

Operates in conjunction with the compressor unloading mechanism. Automatically controls the air pressure in the air supply system between the desired predetermined maximum and minimum pressures. Direct compressor or remote mount. 1/8-27 NPT ports.

Part No. KN18530 (NEW)



105 - 125 PSI.



PRESSURE RELIEF (SAFETY) VALVES

PRESSURE RELIEF VALVE

Brass body and stainless steel spring. Factory set at 150 PSI. 1/4"NPTF

Part No. 1031200



ST-3 SAFETY VALVE

75PSI Pressure setting, 1/4" port.

Part No. 285850



Safety Valve Kit ST-4

The ST-4 Safety Valve is installed in the extra compressor discharge port, if available, or the discharge line to prevent compressor damage in the event of discharge line blockage. Because of this a standard safety valve may not be used. 250 psi.

Part No. 131081

1/2-14 NPT

Part No. 801116

7/8-14. UNF-2A

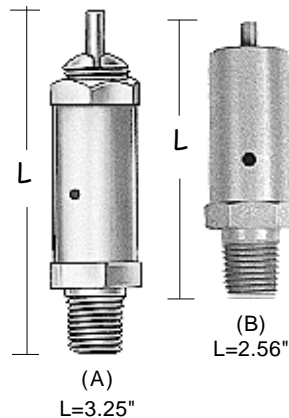

SAFETY VALVE

Protects against excessive pressure in air system. Installs in the supply reservoir. Factory set at 150 PSI. Can be adjusted. Automatically closes after excess pressure is released to atmosphere. 1/4" PT.



(A) Part No. 205105N

(B) Part No. 284142N

(B) Part No. 285849N (175 psi)



PRESSURE PROTECTION VALVES

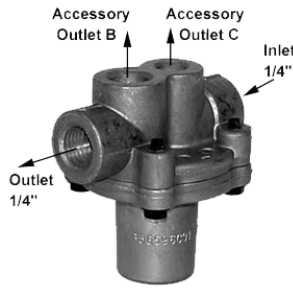

PRESSURE PROTECTION VALVE

Used to protect air brake system from accessory failure. Nonadjustable.
 1/4" NPTF inlet port,
 1/4" NPTF outlet port.

Part No.	Operating PSI	
	Open	Closed
KN31000	65	45
KN31010	95	75

PRESSURE PROTECTION VALVE with one way check valve



Used to protect air brake system from accessory failure. Nonadjustable. 3/8" NPTF inlet port, 1/2" NPTF outlet port.

Part No.	Opening Pressure
KN31170	50 PSI
KN31171	75 PSI



Part Number 90554107

Pressure Protection Valve

Protects the air brake system in the event of a leak or failure within the air suspension system. A replaceable filter minimizes contaminants and other debris from entering other air system accessories.

All Ports: 1/4" NPT

Closing Pressure: 70 PSIG

Opening Pressure: 75 PSIG minimum



TRACTOR PROTECTION VALVE Part No. KN34110X

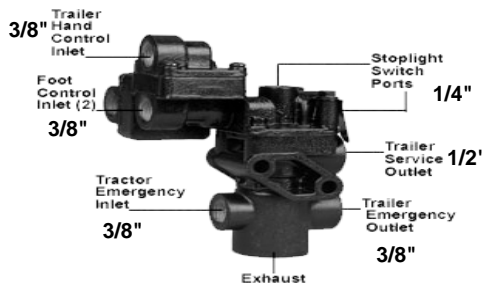

Tractor Protection Valve TP-3DC Part No. 065706

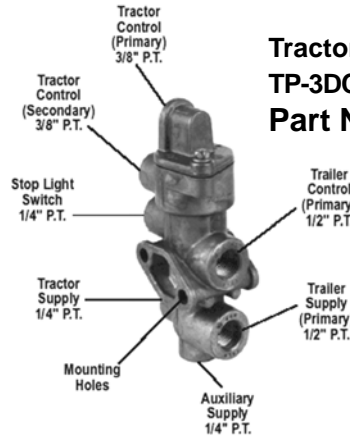

TP-5™ TRACTOR PROTECTION VALVE Part No. 288605N OR288605X

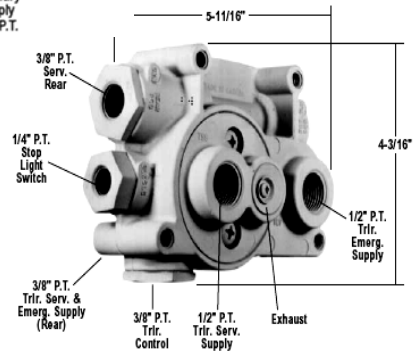

PRESSURE PROTECTION VALVE TYPE PR-4

Closes at a preset pressure. Factory set at 85 PSI. Many different applications. Can be used to protect one reservoir system from another if a reservoir system failure occurs. Nonadjustable. 1/4" PT supply and delivery ports.

Part No. 286500N



PRESSURE PROTECTION VALVE; TYPE PR-2

Closes at a preset pressure. Factory set at 65 PSI. Can be used to protect one reservoir system from another if a reservoir system failure occurs. 1/4" PT supply and delivery ports.

Part No. 277147N

Part No. 277227N (75 psi)

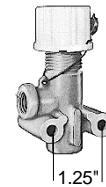

TP-3 TRACTOR/TRAILER PROTECTION VALVE

Part No.	A	B
279000N	1/2"	1/2"

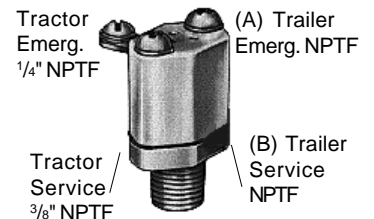

PRESSURE CONTROL VALVE



Pressure setting from 0 psi to reservoir pressure. 1/4" NPTF inlet and outlet. 1/4" NPTF exhaust

Part No. 5400

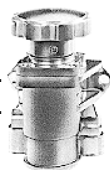

PRESSURE PROTECTION VALVE

3/8" NPTF Inlet,
 3/8" NPTF Outlet

Part No.	Operating PSI	
	Open	Closed
110257	75	70
110258	95	90



PRESSURE PROTECTION VALVE 3/8" NPTF Inlet and Outlet

Part No.	Normal closing pressure	
	2-9/16" tall	
140270	3/8" - 60 psi	
140280	3/8" - 70 psi	
140380	1/4" - 70 psi	



CHECK VALVES

SINGLE CHECK VALVE
SC-2 Steel Seat

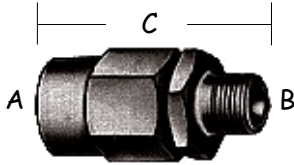

Part No.	A	B	C
800372	1/2" PT	1/2" PT	2.92"
800373	3/8" PT	3/8" PT	2 ⁵ / ₃₂ "

The 800372 single check valve is also available in Fleetcraft:
Part No. FC800372

SINGLE CHECK VALVE
SC-1 Steel Seat

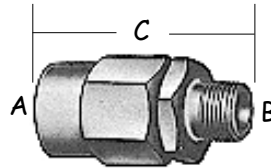

Part No.	A	B	C
800375	1/4" PT	1/4" PT	2 ³ / ₃₂ "

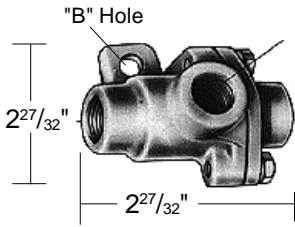

DC-4
DOUBLE CHECK VALVE
All Ports: 3/8" NPTF
"B" Hole: 1¹/₃₂" Dia.
Part No. 278614N



DS-2™
DOUBLE CHECK VALVE with STOP LIGHT SWITCH
Part No. 286452N
Ports 3/8"

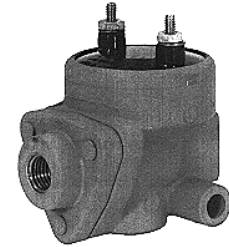

DC-4 DOUBLE CHECK VALVE

Part No.	A	B	C	D	E
278595N	1/4" PT	1/2" PT	1/4"	2.75"	1/4"
278597N	1/4" PT	3/8" PT	1/4"	2.75"	1/4"
278598N	3/8" PT	3/8" PT	1/4"	2.75"	3/8"

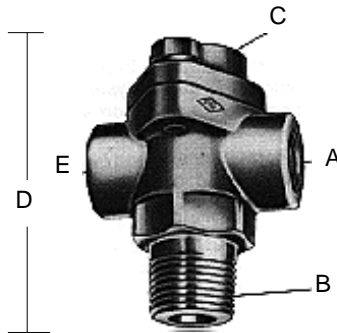

The double check valve is used when a single function or component must be controlled by either of two valves. The double check valve permits either, but not both control valves to operate the device connected to its outlet port.

DC-4
DOUBLE CHECK VALVE
All Ports: 1/4" NPTF
"B" Hole: 1¹/₃₂" Dia.
Part No. 278615N

TWO WAY CHECK VALVE
(Diaphragm Type)
Mount in any position
Use in place of ball or shuttle types
Used when two inputs must become one input.



SINGLE CHECK VALVE
SC-2 Steel Seat

Part No.	TYPE	A	B	C
KN23000	A	1/2" PT	1/2" PT	2.46"
KN23010	A	3/8" PT	3/8" PT	2.47"

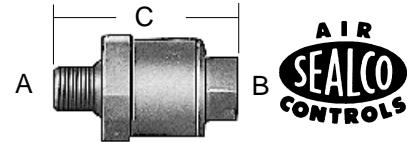

Inlet B: 3/8"
Inlet D: 3/8"
Outlet C: 3/8"
Part No. KN25060

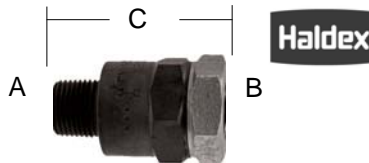
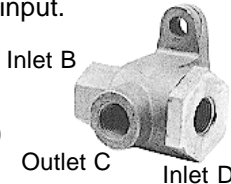

SINGLE CHECK VALVE
SC-1 Rubber Seat

Part No.	A	B	C
10200-3/8	3/8" PT	3/8" PT	2 ¹³ / ₁₆ "
10200-1/2	1/2" PT	1/2" PT	2 ¹³ / ₁₆ "

TR-3™ INVERSION VALVES

NOTE: With common control & supply pressure inlet opens at "A" P.S.I. descending pressure and exhaust opens at "B" P.S.I. ascending pressure.



Part No. 280758N A= 45 psi, B= 60 psi
Part No. 281459N A= 25 psi, B= 40 psi
Part No. 101450N A= 25 psi, B= 40 psi

101450N is a special-duty bus application.

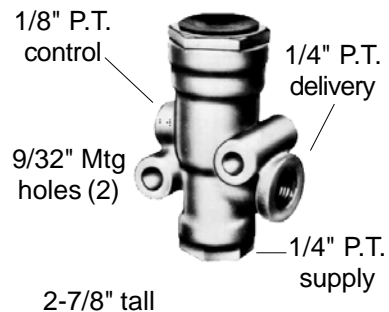



QUICK RELEASE VALVES

Part No.	Ports	
	Supp	Del
1032005	3/8"	3/8"
1032011	1/2"	3/8"



Part No.	Cracking Pressure	Port Size (NPTF)		
		(A)	(B)	(C)
2000D1/2	0-1PSI	1/2"	3/8"	3/8"
2000D3/8	0-1PSI	3/8"	1/4"	1/4"

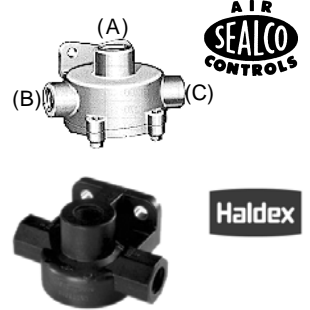

Aluminum Die Cast Body
Supply/Delivery
Differential 0 PSI **TRAMEC**

Part No.	Inlet Port	Delivery Ports	Differential PSI
KN32050	1/2"	3/8"	6
KN32060	3/8"	3/8"	6

QUICK RELEASE VALVES -
Used wherever a quick release function is required in the air brake system.
Aids in meeting FMVSS 121 timing requirements.



QRN - Lightweight, nonmetallic. Mounting holes 11/32" diameter on 1 1/2" centers.



QRN-2 Part No.	Inlet Port	Delivery Ports	Differential PSI
800064	3/8"	3/8"	0
800063	1/2"	3/8"	0



Part No.	Delivery	Supply	Supp/Delivery
			Differential Del. (PSI)
802745	3/8" PT	1/2" PT	1 Max.
802743	3/8" PT	3/8" PT	1 Max.
802741	3/8" PT	3/8" PT	5-8

QR-1C - With Double Check Valve
A dual function valve.
Serves the spring brake chambers as a QR valve; the double check valve prevents a service and emergency brake application from occurring at the same time.



Part No.	Supply	Delivery
289182N	1/4"	1/4"
289714N	1/4"	3/8"

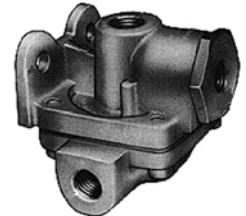

QR-1 Part No. 229859N
Supply Ports: 3/8"
Delivery Ports: 3/8"
Mounting holes on 1 1/2" centers.
Crack Pressure: 0 psi.

QR-1 Part No. 229860N
Supply Ports: 1/2"
Delivery Ports: 3/8"
Mounting holes on 1 1/2" centers.
Crack Pressure: 0 psi.

QR-1 Part No. 288251N
Supply Ports: 3/8"
Delivery Ports: 3/8"
Mounting holes on 1 1/2" centers.
Crack Pressure: 0 psi.
Has 3/8" exhaust port.



Also available as Outright Reman. (OR229859X, OR229860X)-No Core.

LQ-2™ - Limiting and Quick Release Valve
Part No. 229505N
A dual function valve.
Mounting holes on 1 1/2" centers.
Crack Pressure: 0 psi.
Has CPT exhaust port.
Supply Port: 3/8"
Delivery Ports (2): 3/8"
Control Port: 1/4"

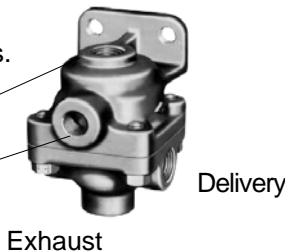

QR-L Part No. 800333
Supply Ports: 1/2"
Delivery Ports: 1/2"
Direct mount, in-line quick release valve.





CONTROL VALVES

MV-3 CONTROL MODULE

An integrated control assembly for control panel mounting in tractor. It provides all the federal legal requirements for trailer air supply and parking brake control and permits the tractor parking brakes to be applied while air is supplied to the trailer. Six 1/4" ports.

Six 1/4" ports.
Nonmetallic. Designed to supersede the MV-2 valve.
Different mounting separates styles.

Part No. 800257 - Fig. 1, .27 Push in fittings.

Part No. 800516 - Fig. 1, 1/8" Exh. Port.

Part No. 800517 - Fig. 2

Part No. 800518 - Fig. 1, 1/8" Aux. Port.

Part No. 800519 - Fig. 1, 1/8" Exh. Port.

Part No. 800521 - Fig. 3, 1/4-20.

Part No. 800523 - Fig. 1, #10-24

Part No. 800573 - Fig. 1, 1/4-20.

Part No. 800622 - Push in fittings.

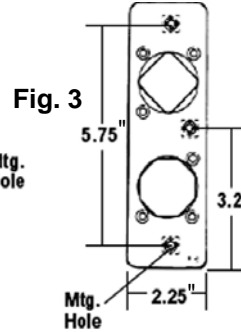
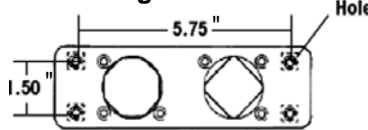
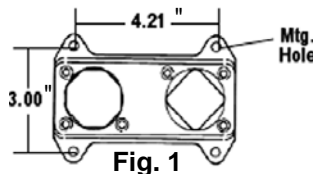
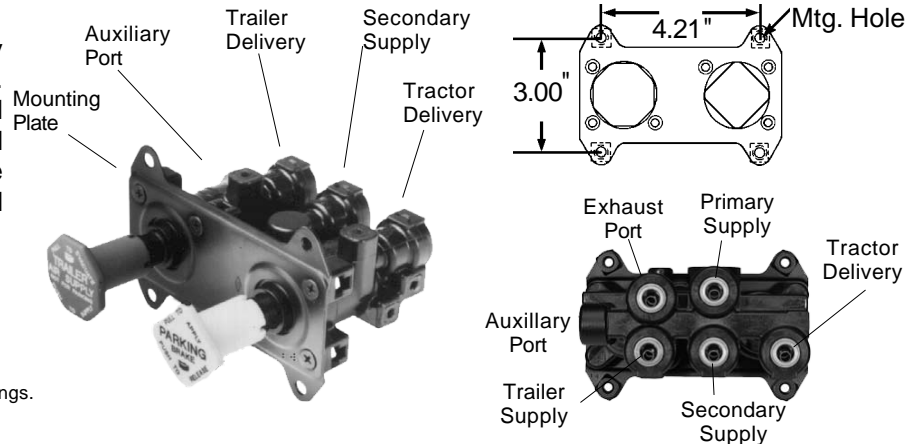

Check Valve Surface Material
• Plastic - "Old Style"
• Aluminum "New Style"

MV-3 MODULE MAINTENANCE KITS



MAINTENANCE KIT PART No. 107216 CONSISTING OF:					
KEY No.	QTY	DESCRIPTION	Key No.	QTY.	DESCRIPTION
1	2	O-RING	7	2	PLUNGER SPRING
2	2	O-RING	8	1	O-RING
3	2	O-RING	9	1	O-RING
4	2	O-RING	10	1	OVERRIDE SPRING
5	2	EXHAUST SEAL	11	1	SPRING
6	2	O-RING	12	1	CHECK VALVE

SHUTTLE KIT PART No. 107217		
KEY No.	QTY.	DESCRIPTION
13	1	RETAINING RING
14	1	SHUTTLE VALVE
15	1	O-RING
16	1	O-RING
17	1	O-RING

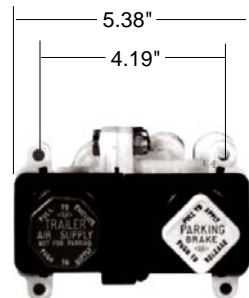
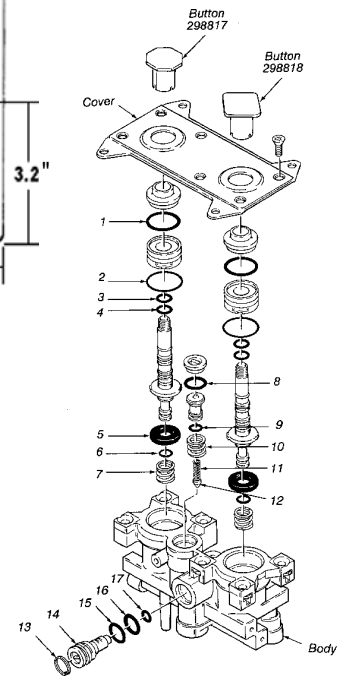

MV-2 CONTROL MODULE

An integrated control assembly for control panel mounting in tractor. It provides all the federal legal requirements for trailer air supply and parking brake control and permits the tractor parking brakes to be applied while air is supplied to the trailer. Six 1/4" ports. Nonmetallic. **Part No. 101437N**

MV-2 SPOOL INSERTS

The MV-2 control module is serviced by replacement of the complete spool inserts.



PP-DC Control Valve Part No. 065661

Mounting Hole 1/4"-20 THD.
Port Type Push to connect w/ 3/8" O.D. tubing



PP-DC Control Valve Maintenance Kit Part No. 5006939



MANIFOLD DASH VALVE

Engineering Grade Composite (EGC) - One Piece Housing. Ports have molded identification. Completely serviceable. 2 Spools. All ports 1/4" NPTF. Red and Yellow knobs included. **Part No. KN20615**
Part No. KN20607 (3/8" ports)





PUSH PULL VALVES

PUSH PULL CONTROL VALVE

PP-5 (w/pilot air release)

A pressure sensitive on-off control commonly used with vehicle torque converter system, engine speed control, and some parking brake systems. Automatic release pressure 40 PSI. 1/8" supply, 1/8" delivery and exhaust, all NPTF.



Part No. 281946N

PUSH PULL CONTROL VALVE PP-1

A pressure sensitive on-off control usually used to control parking and emergency brakes. 1/8" supply, 1/4" delivery and exhaust, all NPTF.



Part No.	Automatic Release Pressure
276566N	20 PSI
276567N	40 PSI
287417X	30 PSI
239357N	7/8 hex nut

PP-7 Push-Pull Control Valve Trailer Supply Valve

Automatic release pressure 40 PSI. 1/4" del. 1/8" control and supply.



Part No. OR288239X
Part No. 106113 (Basic)
Part No. OR288241X (1/4" exhaust)

HAND CONTROL VALVE

Pull-push with Automatic Shut-Off. Shut-off 30±5 PSI. 1/4" outlet and inlet, 1/8" exh. Includes knob/nameplate.

Part No. 99600B



PUSH-PULL STYLE VALVE



Controls parking /emergency brakes. Pop pressure: 35±10 PSI. 7/8" mounting hole required. Knob included. Made of Engineering Grade Composite. All ports 1/8" NPTF.

Delivery

Supply

Exhaust

Delivery

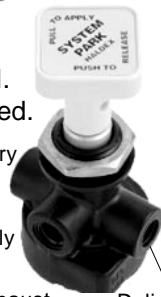

PUSH-PULL VALVE 3-way

Bulkhead mount, fits 5/8" dashboard hole. All ports 1/4". Made of aluminum. Complete with boot and knob.

Part No. A83580

Outlet

Exhaust

Inlet



HAND CONTROL VALVE Park Brake release.

Manual Pull-push with 2-hole mounting. All 1/4" NPT port sizes Used outside on dollies and trailers. Includes knob/nameplate.

Part No. 17600B



PUSH-PULL STYLE VALVE



Control tractor only parking. Bulkhead mount; 7/8" hole required. Will not stay in half-on, half-off position. All ports 1/8-27 NPTF. Pop pressure 17.7

Part No. KN20035



PUSH-PULL STYLE VALVE

Controls tractor protection. Made of Engineering Grade Composite. Exhaust / Delivery ports: 1/4-18 NPTF. Supply / Control ports: 1/8-27 NPTF. Pop Pressure: 35 PSI. 7/8" mounting hole required.

Part No. KN20025

Supply

Delivery

Control



PUSH-PULL STYLE VALVE

Panel mount. Made of EGC plastic. All ports 1/4" NPTF.

Part No.	Pop Pressure
KN20031	25-35 PSI
KN20033	7-17 PSI



Supply



Delivery

Exhaust (not threaded)

KNOBES FOR PUSH-PULL VALVES



Pin type.
RCCC red.
Pin included.
Part No. KN20900



Pin type.
RCCC yellow.
Pin included.
Part No. KN20901



Pin type.
RCCC blue.
Pin included.
Part No. KN20902



Pin type.
RCCC yellow.
Pin included.
Part No. KN20903



Threaded type.
RCCC yellow.
Pin included.
Part No. 12509



Threaded type.
RCCC red.
Pin included.
Part No. 12501

Red Pin type.
Part No. 298817N



Yellow Pin type.
Part No. 298817N



NOTES:

All knobs made of Engineering Grade Composite. Threaded knobs have 1/4-20 threads.





LEVER STYLE VALVES / TRAILER BRAKE CONTROL VALVES

DOUBLE FLIPPER STYLE VALVES

Panel mount, directional air control valve. May be used for control of push-pull air cylinders or various other air operated devices. Supply ports 1/4" NPTF Delivery Ports (2) 1/8" NPTF



PART No.	APPLY/RELEASE POSITIONS
KN20080	3 position with manual release only.

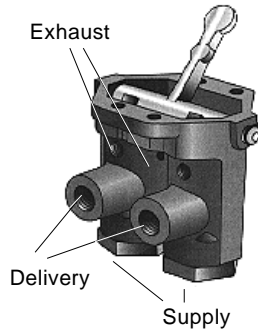

LEVER CONTROL VALVE

All ports 1/8" NPTF Complete with face plate. Part No. 21600

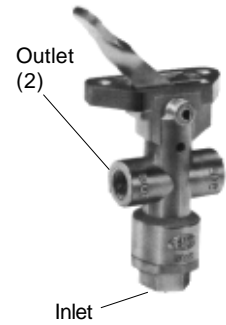

FLIPPER STYLE VALVE

Panel mount. On-off nonautomatic two position valve. Made of Engineering Grade Composite. All Ports 1/8". Mounting holes on 1.5" centers. Part No. KN20001

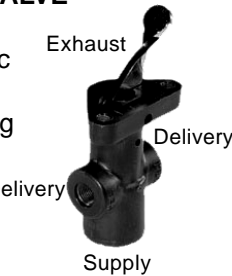

TW-3 LEVER TYPE CONTROL VALVE

Used in parking and emergency brake systems. 1/4" supply and delivery ports. Part No. OR283040X

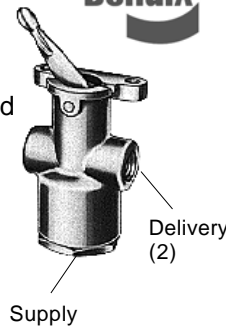

TW-1 CONTROL VALVE

Two position steel valve with chrome handle. All ports 1/8" NPTF. Dial plate not included. Part No. 229635N (also as Outright Reman-no core)

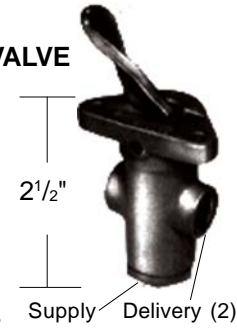

TRAILER BRAKE CONTROL VALVES

TRAILER BRAKE CONTROL VALVE

In column mount. Made of Engineering Grade Composite. Handle applies 50° maximum. Handle and knob not supplied. All 1/4" ports. Holding Type: Part No. KN20541



TRAILER BRAKE CONTROL VALVE

External steering column mount. Handle applies 70° maximum. Chrome handle. All ports 1/4" NPTF. Holding Type: Part No. KN20561



TRAILER BRAKE CONTROL VALVE

GM in-column mount. Made of Engineering Grade Composite. Handle rotates 72° maximum. 3/8" NPTF deliver and supply ports, 1/8" exhaust. Special tube nuts in ports. Holding Type: Part No. KN20551



TW-4 CONTROL VALVE 1/8" Ports

Part No. 110376 Used with part no. 110257.

Used on trailer turnable axles, converter dollies and trailers exempt from spring brakes. 3/8" NPT ports.



TRAILER EMERGENCY VALVE / SV-1 SYNCHRONIZING VALVES

TEV Valve Provides Spring Brake Priority

-Retains the ability of the driver to repeatedly apply and release the Parking/Emergency Brakes even with a damaged tank. Part No. 51301



STEV Valve Provides Spring Brake Priority

-Assures that the trailer parking brakes will not release before there is sufficient air pressure in the reservoir to apply service brakes. Part No. 51321

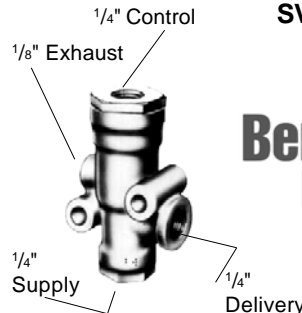

SV-1 SYNCHRONIZING VALVE



A pneumatic control valve. Controls air from remote air supply other than control air supply. All threads NPTF.

With common control and supply pressure, inlet opens at "A", and exhaust opens at "B".

Part No.	A PSI	B PSI
278825N	42	28
282472N	21	11
283700N	62	50





SPRING BRAKE CONTROL VALVES

SR-5 TRAILER SPRING BRAKE VALVE

Die-cast aluminum, reservoir mounted valve that controls up to four spring brake actuators during parking or emergency applications. All threads NPTF. **Anti-Compounding:**
Part No. 065437
Part No. OR109615X

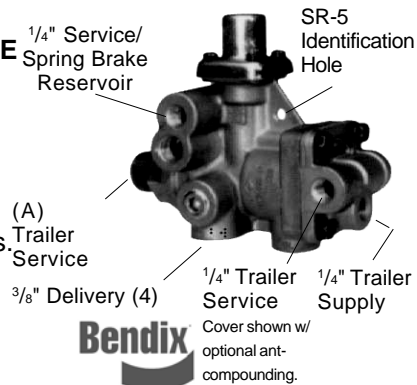

R-7 MODULATING VALVE

Usually found on vehicles with dual air brake systems, the R-7 modulates the spring brakes thru the application of the foot brake valve in the event of loss of rear axle service brake pressure. Spring brake pressure is limited to 0-95PSI by the R-7.
Part No. 103081N / Part No. OR103081X

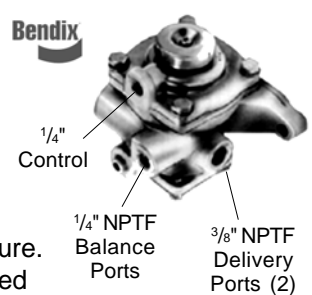

MULTIFUNCTION RT-4 SPRING BRAKE VALVES

Meets all FMVSS-121 trailer requirements for spring brake control and other regulations.

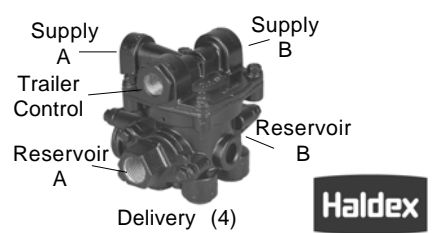

PART No.	TRAILER SUPPLY		TRAILER CONTROL	RESERVOIR		DEL'Y	PPV CLOSING PRESSURE
	A	B		A	B		
KN26010	3/8"	X	3/8"	1/2"	3/8"	(4)3/8"	70 PSI
KN26020	X	3/8"	3/8"	1/2"	3/8"	(4)3/8"	70 PSI

SR-1™ SPRING BRAKE VALVE

Part No. OR286364X
 1/4" PT ports.
 55 psi reservoir trip pressure.
Part No. 288063N (30 psi)



SR-2™ TRAILER SPRING BRAKE VALV

Part No. 103061N
 1/4" PT Service/Supply ports.
 3/4" male PT reservoir, 3/8" delivery (4)



SR-4™ TRAILER SPRING BRAKE VALVE

Part No. 101622X
 1/4" PT Service/Supply ports.
 1/2" male PT reservoir, 3/8" delivery (4)



SPRING BRAKE CONTROL VALVES

Protected Reservoir System
 Four delivery ports.
 Cover ports in line with reservoirs.

Part No.	Port (A)	Port (B)
110171	1/2" NPTF	3/8" NPTF
110191	3/8" NPTF	1/2" NPTF

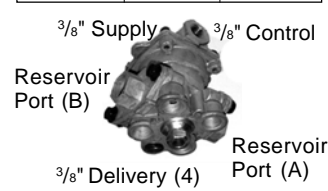

SPRING BRAKE CONTROL VALVES

Protected Reservoir System
 Four delivery ports.
 Cover ports opposite of reservoirs.

Part No.	Port (A)	Port (B)
110170	1/2" NPTF	1/2" NPTF
110315	1/2" NPTF	3/8" NPTF

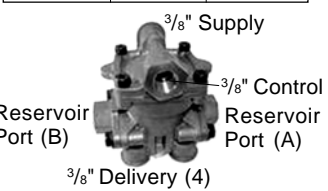

SPRING BRAKE EXHAUST

Part No. 3800
 Tee mounted pressure and quick release valve. on spring brake applications. Prevents unwanted application of spring brakes due to drop in supply pressure. 1/4" NPT ports. 1 15/16"
Part No. 7800
 Tee Mounted Same application as 3800.

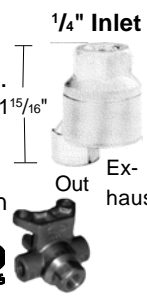

TRAILER CONTROL LINE VALVE

Part No. 110580
 Provides a balanced control line signal for uniform braking of multi-axle combination vehicles. 3/8" control port, 1/2" res. port, 3/8" del (2) Includes bracket. Nom. crack pressure 0.0 psi



SPRING BRAKE CONTROL VALVE

Service Reservoir Priority System
 Complies with all changes to FMVSS121. Designed for use with a single reservoir on a typical single or tandem axle trailer application.
Part No. 110700

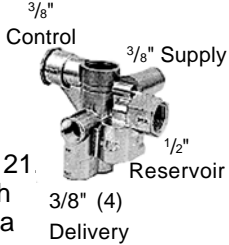

Note: All of these can be used with (2) 1400 cu. in. reservoirs on tandem axle trailers.
 Plug kit for **110500 and 110700**
Part No. 110515

SPRING BRAKE CONTROL VALVE

Spring Brake Priority System
 Complies with all changes to FMVSS121. Designed for use with a single reservoir on a typical single or tandem axle trailer application.
Part No. 110500 (110500 pictured)
Part No. 110501
Repair kit for 110500
Part No. 110800 Has relay feature, fills from the tank

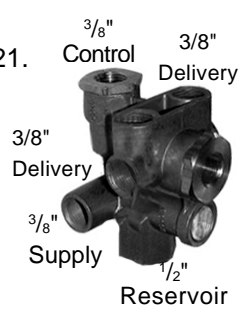

LINE FILTER

Used in trailer supply line ahead of spring brake control valve or relay emergency valve.
Part No. 2550

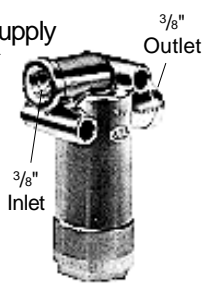

Sealco does not recommend use in trailer control line.





RELAY VALVES - BENDIX

R-12™ RELAY VALVE

Piston operated, with 4 delivery ports for service or parking brakes.
Crack pressure: 4 PSI unless noted.



(A) Part No. 065104

- 3/8" Vertical Delivery Ports
- 1/2" Supply Ports
- 1/4" Service Port

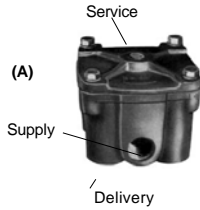

Part No. 102626N

- 1/2" Vertical Delivery Parts
- 1/2" Supply Ports
- 1/4" Service Port

(B) Part No. 103009N

- 1/2" Horizontal Delivery Ports
 - 3/4" Supply Ports
 - 1/4" Service Port
- Part No. 065125**
- 1/2" Horizontal Delivery Ports
 - 1/2" Supply Ports
 - 1/4" Service Port

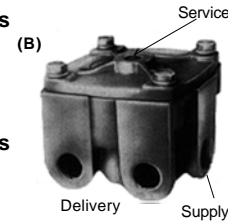

(C) Part No. 065206 R-12™ Relay Valve Vert. (2) & Horizontal Delivery Ports

- 3/8" Delivery Ports
- 1/2" Supply Ports
- 1/4" Service Port

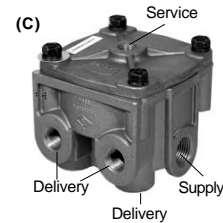

Part No. 102802N

Maintenance Kit for R-12 & R-14 Valves.

KIT INCLUDES:

Key	Qty.	Description
1	1	O-Ring
2	1	O-Ring
3	1	Valve Retainer
4	1	Inlet & Exhaust Valve
5	1	Valve Spring
6	1	Retaining Ring
7	1	Exhaust Cover
8	1	O-Ring
9	1	O-Ring
10	1	Diaphragm
11	1	O-Ring

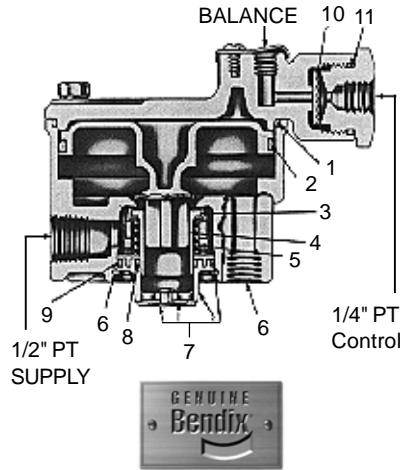

R-14 RELAY VALVE

Anti-compounding feature permits control of spring brakes as well as service brakes.
Has 4 delivery ports.
Crack Pressure: 4 PSI

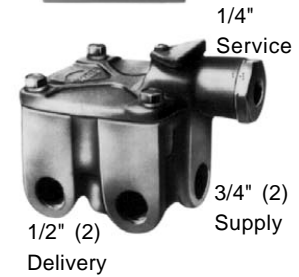

Horizontal Delivery Ports

Part No. 103010N

Part No. 104574

(with 1/2" supply, & bracket)



Vertical Delivery Ports

Part No. 103028N

R-12DC™ RELAY VALVE with double check valve

4 delivery ports NPT.
2 Horizontal and 2 Delivery.
Crack pressure: 4 PSI.



Part No. 800481

- 3/8" Vertical Delivery Ports (2)
- 1/2" Supply Ports (2)
- 1/2" Horizontal Delivery Ports (2)

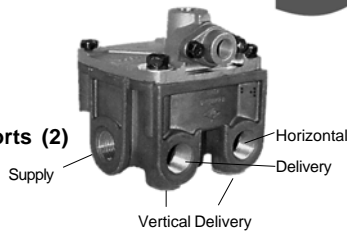

RE-6™ RELAY EMERGENCY VALVE

4 delivery ports (2) A.P.T., (2) P.T.

Part No. 281865N

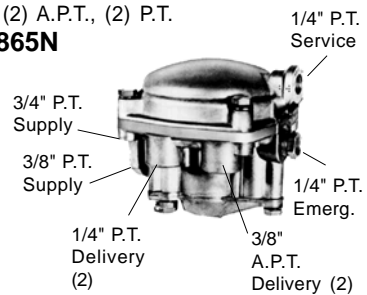

AR-1™ Antilock Relay Valve Part No. 800297

The AR-1™ antilock relay valve is a specialized brake relay valve. It is essentially an R-14™ relay valve with a special cover that permits direct attachment of an antilock controller. Like the R-14™, the AR-1™ incorporates a quick release valve adjacent to the service port which provides for rapid exhaust of control air pressure.

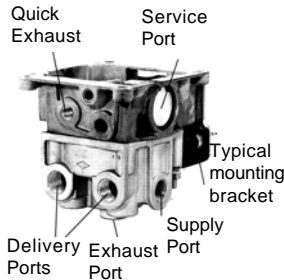

BP-R1™ Bobtail Brake Proportioning Relay Valve

- Maintenance Kit 106392
- Universal Mounting Bracket 296010 furnished with valve
- Outright Reman - no core.

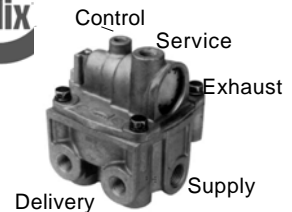

PART No.	SERVICE	SUPPLY	DELIVERY	AUX RES.	CON-TROL	CRACK PRESSURE
OR65145X	1/4"	1/2"	3/8"	(1)	1/8"	4
OR65146X	1/4"	1/2"	3/8"	(1)	1/8"	5.5



RELAY VALVES - BENDIX CORELESS VALVES

Bendix Coreless® Valves - Outright Reman Program.

The Coreless® valves program gives you virtually 100% coverage of the Bendix remanufactured valve line. Forget about carrying remanufactured valves with core obligation as part of your regular inventory. With expanded product coverage, it has never been easier to make the jump to Coreless. (Available in other valves as well besides Relay Valves!)



R-12™ RELAY VALVE

Piston operated, with 4 delivery ports for service or parking brakes.
Crack pressure: 4 PSI unless noted.

(A) Part No. OR102626X

- 1/2" Vertical Delivery Ports
- 1/2" Supply Ports
- 1/4" Service Port

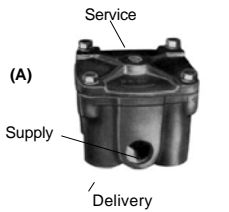

(B) Part No. OR103009X

- 1/2" Horizontal Delivery Ports
- 3/4" Supply Ports
- 1/4" Service Port

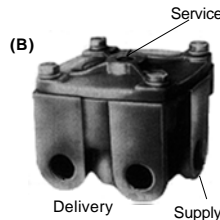

R-14 RELAY VALVE

Anti-compounding feature permits control of spring brakes as well as service brakes.
Has 4 delivery ports.
Crack Pressure: 4 PSI

Horizontal Delivery Ports Part No. OR103010X

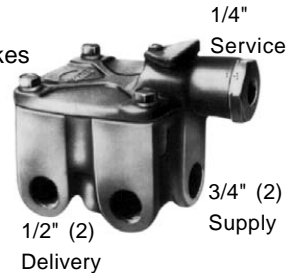

Vertical Delivery Ports Supply is 1/2" Part No. OR103028X



R-6™ RELAY VALVE

4 delivery ports 3/8" Supply ports 3/8"
Part No. OR279180X

R-6™ RELAY VALVE

270 degrees port service angle
4 delivery ports 3/8"
Supply ports 3/8"
4 Hole mounting flange
Part No. OR283940X



R-8™ RELAY VALVE

90 degrees port service angle
1/4" P.T. Service Port
1/8" P.T. Balance Port
Includes exhaust cover
Part No. OR286370X



R-8P™ RELAY VALVE

2 Supply ports 3/4"
3/8" P.T. Service Port
2 1/2" P.T. Delivery Ports (1 1/4")
Part No. OR287114X



R-12P™ PILOT RELAY VALVE

4 delivery ports 3/8"
2 Supply ports 1/2"
Control Port 1/4"
Part No. OR109264X



RE-6™ RELAY EMERGENCY VALVE

4 delivery ports (2) A.P.T., (2) P.T.
Part No. OR281865X

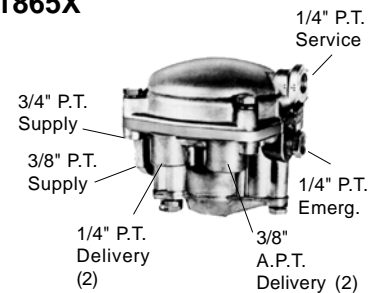

RE-6™ RELAY EMERGENCY VALVE

4 delivery ports (2) A.P.T., (2) P.T.
A.P.T. delivery is 1/4" vs OR281865X
Part No. OR281860X

BP-R1™ Bobtail Brake Proportioning Relay Valve

- Maintenance Kit 106392
- Universal Mounting Bracket 296010 furnished with valve
- Outright Reman - no core.

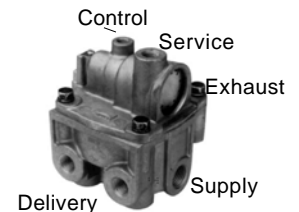

PART NO.	SERVICE	SUPPLY	DELIVERY	AUX RES.	CON-TROL	CRACK PRESSURE
OR65145X	1/4"	1/2"	3/8"	(1)	1/8"	4
OR65146X	1/4"	1/2"	3/8"	(1)	1/8"	5.5



RELAY VALVES - SEALCO

2 PORT SERVICE RELAY

Used primarily for single axle trailer service brakes, or axle by axle trailer brake designs.
Nipple mounted.
Crack Pressure 4 PSI.
Control Port: 3/8" NPTF
Reservoir Port: 1/2" NPTF
Delivery Ports: 3/8" NPTF
Part No. 110410



2 PORT SERVICE RELAY VALVE LOV-2

Control Port : 3/8" NPTF
Reservoir Port: 1/2" NPTF
Delivery Ports (2): 3/8" NPTF
Cracking Pressure 1.5 PSI
Part No. 110360



2 PORT DELIVERY

Used primarily for single axle trailer service brakes, or axle by axle trailer brake designs.
Nipple mounted.
Crack Pressure 4 PSI.
Control Port: 3/8" NPTF
Reservoir Port: 1/2" NPTF
Delivery Ports: 3/8" NPTF
Part No. 110197



4 PORT DELIVERY

Crack Pressure 4.5 PSI.
Comes with "ratio feature."
Aux. Supply Port: 3/8" NPT
Control Port: 3/8" NPT
Reservoir Port: 3/4" NPT
Delivery Ports: 3/8" NPT (4)
Part No. 110139



4 PORT SERVICE RELAY VALVE LOV

Control Port: 3/8" NPTF
Reservoir Port: 3/4" NPTF
Delivery Ports (4): 3/8" NPTF
Cracking Pressure 1.5 PSI
Part No. 110380



4 PORT SERVICE RELAY VALVE

Used primarily for tandem axle trailer service brakes with four brake chambers.
Nipple mounted.
Crack Pressure 4 PSI.
Control Port: 3/8" NPTF
Reservoir Port: 3/4" NPTF
Delivery Ports: 3/8" NPTF
Part No. 110415



RELAY EMERGENCY VALVE

4 Delivery Ports
The Original "Quick Fix"
Nipple mounted.
Crack Pressure 1.5 PSI.
Control Port: 1/4" NPTF
Reservoir Port: 1/2" NPTF
Emerg.-Supply: 1/4" NPTF
Delivery Ports: 1/4" NPTF
Part No. A1000S
Replacement Cartridge
Part No. 1000-5A



Mounting Nipple for A1000S
Part No. 616



CHARGING RELAY 4 DELIVERY PORTS EMERGENCY VALVE

Control Port : 3/8" NPTF
Emerg.-Supply Port : 3/8" NPTF
Reservoir Port : 3/4" NPTF
Delivery Ports : 3/8" NPTF
Cracking Pressure 4.5 PSI
Part No. 110470



HEAVY DUTY MOUNTING NIPPLES

Straight nipple
1/2" NPT, 1 5/8" long
Part No. 6002S
3/4" NPT, 1 5/8" long
Part No. 6006

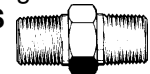

Reducing Nipple
3/4" to 1/2" NPT, 1 5/8" long.
Part No. 6003

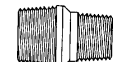

NON-CHARGING RELAY EMERGENCY VALVE

Commonly used on converter dollies, turntable axles, and air lift axles with service brake chambers.

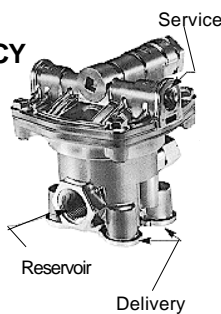

Serv-Control Port (2): 3/8" NPTF
Emerg.-Supply Port: 3/8" NPTF
Reservoir Port: 3/4" NPTF
Supply-Out Port: 3/8" NPTF
Delivery Ports (4): 3/8" NPTF
Cracking Pressure 4.5 PSI
Part NO. 110338X

CHARGING EMERGENCY 4 PORT RELAY VALVE

Crack Pressure 4.5 PSI.
Comes with "ratio feature."
Supply Port: 1/4" NPT
Control Port: 1/4" NPT
Reservoir Port: 3/4" NPT
Delivery Ports: 3/8" NPT (4)
Part No. 110200

Crack Pressure 4.5 PSI.
Comes with "ratio feature."
Supply Port: 3/8" NPT
Control Port: 3/8" NPT
Reservoir Port: 3/4" NPT
Delivery Ports: 3/8" NPT (4)
Part No. 110205

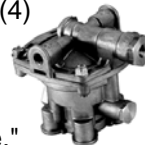

CONTROL LINE RELAY EMERGENCY VALVE for Non-ABS Applications.

Commonly used on converter dollies, and turntable axles on pull, transfer and B-train type trailers.
Control Port : 3/8" NPT
Reservoir Port: 1/2" NPT
Dolly Port: 3/8" NPT
Delivery Ports (4): 3/8" NPT
Nominal Crack Pressure 0.0 PSI
Part NO. 110570
includes bracket as shown.





RELAY VALVES - HALDEX



EMERGENCY RELAY VALVE

4 port. Suitable for pre-121 trailers, converter dollies, or exempt trailers.
Crack pressure 3.0 PSI

(1)=Plugged
* = non-charging

PART No.	SERVICE	EMERG.	DELIVERY	AUX	RES.
	INLET	INLET		RES.	
KN30200*	3/8"	3/8"	3/8"	(1)	1/2"
KN30300	1/4"	1/4"	1/4"	(1)	3/4"
KN30400	1/4"	1/4"	3/8"	(1)	3/4"



RELAY VALVES(RG2)

2 Delivery Ports. Compact size. A fast, low cracking pressure straight relay for tractor-trailer-truck applications.
Crack pressures 5.6 +/- 1.0 PSI. Cover may be rotated without affecting warranty.

PART No.	RESERVOIR		DELIVERY		INCLUDED WITH VALVE:
	A	B	C	D	
KN28500	3/8"	3/8"	3/8"	3/8"	(1) 3/8" PLUG.
KN28510	3/8"	1/2"	3/8"	3/8"	(1) 1/2". (1) 3/8" PLUG.
KN28520	1/2"	1/2"	1/2"	1/2"	(1) 1/2" PLUG.

RELAY VALVE

2 & 4 Horizontal Delivery Ports. A multipurpose, low differential, high capacity, straight relay. Meets FMVSS-121 timing requirements. Cover can be rotated without affecting performance or warranty.

3/8" delivery ports.
1/2" reservoir ports
3/8" control port
2 Delivery Ports 4.6 PSI crack pressure
Part No. KN28060
4 Delivery Ports
7 PSI Crack Pressure
Part No. KN28080



RELAY VALVE

Four delivery ports facing down. Cracking pressure 3.0 PSI. Meets or exceeds MFMVSS-121 requirements. Cover may be rotated without affecting warranty.

PART No.	CONTROL	DELIVERY	SUPPLY	AUX SUPPLY
A103600	1/4"	3/8"	3/4"	(1)

(1)=Plugged



Remanufactured Relay Valve - Two Port - Single Control Line
Used to apply and release service brakes on tractor or trailer.

Part No. KN28131X
Part No. KN28140X
Supply (2): 1/2"
Delivery (2): 1/2"
Control (1): 1/4"



Built-in anti-compounding two-way check valve for spring brake control.

Part No. KN28071X
Supply (2): 1/2"
Delivery (2): 1/2"
Control (2): 1/4" and 1/8"
Crack Pressure: 4.0± 1 PSI



Remanufactured Fast Air and Balancing (FAB) Relay Valve

Speedup or fast air relay. Used on converter dollies and long wheel base towing trailers to speed the tractor control signal to the rear trailer(s) service brakes. Cover may be rotated without affecting performance or warranty. Two mounting holes: .34 diameter on .50" centers.

KN28300X
Supply (2): 1/2"
Delivery (2): 1/2"
Control (1): 3/8"
Crack Pressure: 0 PSI



RG5 - 2 Delivery Port Relay Valve

Used on 2 tank, 3 valve trailer systems and tractor applications. Compact size.

Made of durable (EGC) Engineering Grade Composite.

All ports are molded-in identification.

Interchangeable with competitive valves.

Corrosion and rust proof.

Crack Pressure: 6.0 PSI

Part No. KN28550

Supply A: 1/2" x 3/8" nipple installed at factory

Supply B: Plugged

Delivery C: 3/8"

Delivery D: 3/8"

Control Port: 1/4"

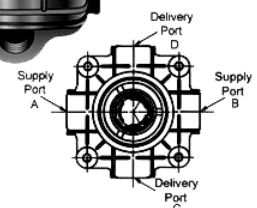
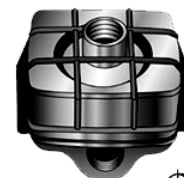



BRAKE (FOOT) VALVES

Part No. 238888N

Folcrum Pin



Part No. 236979N

Mounting Plate

Shown with valve.

Valve not included.



DUAL BRAKE VALVE

The E-6 dual brake valve is a floor mounted treadle or lever operated valve with two separate supply and delivery circuits for service and secondary braking, providing graduated control for applying and releasing vehicle brakes.

Part No. 286171N

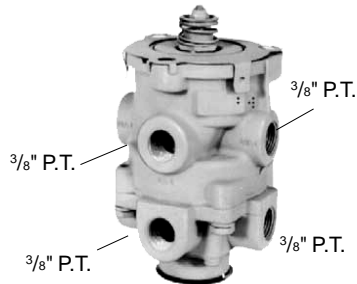

TREADLE ASSEMBLY

Aluminum assembly with no-slip design. Replaces most steel pedals

Part No. SN4017A

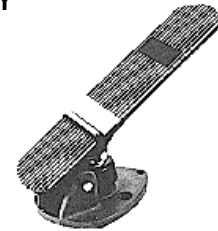

FOOT OPERATED VALVE DUAL CIRCUIT

Provides smooth and consistent pedal feel over competitive application valves. Requires minimal modification for change over. 3/8" ports. Bottom portion of valve made of EGP plastic.

Part No. KN22150



E8P BRAKE VALVE

Lower Body

Rotated 90°

Part No. 800629

(Replaces E-12 065313 AND 800583)

Part No. 800630

(Replaces 065458)

Part No. 800633

(Replaces 065458, has 1/2" NPT exhaust.)



TREADLE ASSEMBLY
Part No. 229938N



BOOT

Part No. 236982N

FULL-FUNCTION (FF2 / FF3) TRAILER VALVES

FF2 FULL FUNCTION TRAILER VALVE

Replaces 2 and 3 valve multifunction trailer air brake systems by providing:

- Trailer spring brake control. •Pressure protection with one-way check.
- Trailer service relay. •Fully complies with FMVSS-121 trailer regulations, for spring brake control and other requirements

Single valve for tandem axle:

- 1 or 2 reservoir systems •Protects supply to 70 PSI; no dragging spring brakes with 70 PSI or higher supply line. •3 second spring brake apply
- Service brake functions •Anti-compounding



Heavy steel walled pipe nipple included with each valve, conforming to NFPA/T3.8.3 R2-1977 standard.

*SPECIAL

*ORDER

PART No.	CRACK PRESSURE	RESERVOIR	CONTROL	SUPPLY	SPRING BRAKE	SERVICE BRAKE
KN28600	3 PSI	3/4"	1/4"	3/8"	3/8"	3/8"
KN28601	3 PSI	1/2"	1/4"	3/8"	3/8"	3/8"
KN28602*	5 PSI	3/4"	1/4"	3/8"	3/8"	3/8"
KN28603*	5 PSI	1/2"	1/4"	3/8"	3/8"	3/8"



Single valve system - easy to install, maintain and troubleshoot. Built-in pressure protection and anti-compounding functions: FMVSS-121 compliant, eliminates broken foundation components caused by compounding of spring brake. Space age engineering grade composites: resists corrosion, lighter and more durable than aluminum. Built-in service and spring brake quick release. Heavy wall mounting nipple is treated to resist corrosion and withstand severe duty applications. Service brake priority ensures air tank pressure is sufficient to stop vehicle when spring brakes are first released. Can be used with single or twin air tanks.



SHUT OFF VALVES / DRAIN VALVES

SHUT OFF VALVE

Ball type valve with 1/2" NPTF both ends. Working pressure 150 PSI. Part No. 12116



DRAIN VALVES WITH CABLE

Use on wet or dry tanks. 1/4" NPTF. Brass body with stainless spring. Nylon coated stainless cable. 4' Cable Part No. FC12104 5' Cable Part No. FC12105



DRAIN VALVES WITH CABLE

Use on wet or dry tanks. 1/4" NPTF. Nylon coated stainless cable.



3' cable Part No. 12103 4' cable Part No. 12104 5' cable Part No. 12105

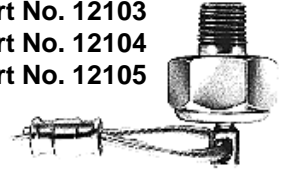

EXTERNAL SEAT DRAIN COCK

NPTF	Part No.
1/8"	DC604-2
1/4"	DC604-4
3/8"	DC604-6
1/2"	DC604-8



DRAIN COCK	
NPTF	Part No.
1/4"	DC601-4
3/8"	DC601-6
1/2"	DC601-8



DRAIN COCK	
NPTF	Part No.
1/8"	DC603-2
1/4"	DC603-4
3/8"	DC603-6



DRAIN COCK Part No. DCR601-4 1/4" NPTF



DRAIN VALVES, AUTOMATIC

Mounted to side; or bottom of wet tank. Functions when pressure varies in air tank. Only one moving part. Cable looped on both ends. 5 Foot cable. 1/4" NPTF Threads



Non-Heated. Part No. KN24000

DV-2™ AUTOMATIC RESERVOIR DRAIN VALVES

The DV-2 automatic reservoirs drain valve is a completely automatic draining device. It is installed directly into the end or bottom drain port of the reservoir and does not require any additional control lines. It operates automatically from ascending and descending reservoir pressures.

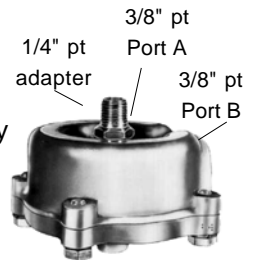

Non-Heated: Part No. OR281923X

Heated: Part No. OR284412X



TRUCK VALVES

Part No.	Female Pipe Thread	Male Pipe Thread
V402P-2-2	1/8"	1/8"
V402P-4-4	1/4"	1/4"
V402P-6-6	3/8"	3/8"

GROUND PLUG SHUT OFF COCK

Female Pipe To Male Pipe



Part No.	Hose I.D.	Pipe Thread
SV404P-6-6	3/8"	3/8"
SV404P-10-6	5/8"	3/8"
SV404P-10-8	5/8"	1/2"
SV404P-12-6	3/4"	3/8"
SV404P-12-8	3/4"	1/2"

TRUCK VALVE Hose To Male Pipe

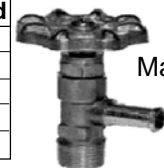

TRUCK VALVE Female Pipe to Male Pipe

Part No.	Hose I.D.	Pipe Thread
V405P-6-6	3/8"	3/8"
V405P-6-8	3/8"	1/2"
V405P-8-8	1/2"	1/2"

Part No.	Hose I.D.	Pipe Thread
V409F-8-6	1/2"	3/8"
V409F-8-8	1/2"	1/2"
V409F-10-8	5/8"	1/2"
V409F-12-8	3/4"	3/8"

TRUCK VALVE Flare To Male Pipe





FLEETCRAFT VALVES

Valves

New outright, one year warranty.



Valves

New outright, one year warranty.

Part No. FC28500

Relay Valve

Straight relay.
3/8" delivery,
3/8" reservoir.
Crack pressure 6 psi.



Part No. FC28510

Relay Valve

Straight relay.
3/8" delivery,
1/2" reservoir.
Crack pressure 6 psi.



Part No. FC28520

Relay Valve

Straight relay.
1/2" delivery,
1/2" reservoir.
Crack pressure 6 psi.



Part No. FC065104

Relay Valve

3/8" vertical delivery ports (4)
1/2" supply. 1/4" service port.
Crack pressure 4 psi.



Part No. FC103009

Relay Valve

1/2" horizontal delivery ports (4)
3/4" supply. 1/4" service port.
Crack pressure 5.5 psi.



Part No. FC102626

Relay Valve

1/2" vertical delivery ports (4)
1/2" supply. 1/4" service port.
Crack pressure 4 psi.



Part No. FC103010

Relay Valve

1/2" horizontal delivery ports (2)
3/4" supply(2). 1/4" service port.
Crack pressure 4 psi.



Part No. FC065437

Spring Brake Control Valve

Mounted on the reservoir,
controls up to 4 spring brakes.
3/8" delivery (4)
1/4" service and supply.
3/8" reservoir B.



Part No. FC103028

Relay Valve

1/2" vertical delivery ports (4)
1/2" supply. 1/4" service port.
Crack pressure 4 psi.



Part No. FC26020

Spring Brake Control Valve

Trailer Supply 3/8"
3/8" delivery (4)
1/2" reservoir A. 3/8" reservoir B.
Closing pressure 70 psi.



Part No. FC281865

Relay Emergency Valve

delivery ports (4)-2APT, 2PT
3/4" and 3/8" supply. 1/4" service



Part No. FC229635

Lever Control Valve

All ports 1/8"



Quick Release Valves - Crack pressure 0 psi
Part No.

FC229859

3/8" del, 3/8" supply.

Part No. FC103081

Spring Brake Control Modulating Valve

3/8" delivery (2)
1/4" balance. 1/4" control.
Controls spring brake pressure to 0-95 psi.



Part No. FC276566

Push Pull Valve-20 psi

1/8" supply, 1/4" delivery and exhaust.



Part No. FC276567

Push Pull Valve-40 psi

Part No. FC288239

Push Pull Valve-40 psi

1/4" delivery 1/8" control and supply. Auto pressure release.



Part No.

FC229860

3/8" del, 1/2" supply.

Part No. FC286171

Dual Brake Valve

All ports 3/8".



Part No. FC289714

Quick release double check valve 3/8" del. 1/4" supply





VELVAC AIR VALVES

Four-Way Push/Pull Valves

Part No. 320121 - Two Position Valve

Part No. 320122 - Three Position, Holding Type Valve



Four-Way Rotary Handle Valve

Part No. 320123

Includes solid one-piece knob and TWO faceplates
(Raise/Lower & Open/Close) (3) 1/4"-18 FPT ports



Four-Way Electronic Solenoid Valve

Part No. 320131

- Features newly designed orifice area increasing airflow
- Manual override switch for manual operation
- (3) 9/32" dia. valve body mounting holes, (5) 1/4"-18 FPT ports
- Exhaust cone filters included (030084 = 1/8" & 030092 = 1/4")



VELVAC AIR CYLINDERS

- **Stainless steel cylinder shaft provides excellent corrosion resistance and extended cycle life.**
- **Lightweight, corrosion resistant, aluminum cylinder tube with die cast aluminum end caps.**
- **Rear Clevis cast as integral part of the cover for improved durability and mounting integrity.**
- **Double acting, Emralon-coated piston cup assures smooth, long lasting operation even in cold weather conditions.**
- **Front end cap assembly includes pressure seal, dirt seal and oil impregnated bronze bushing.**
- **Cylinder tube is imprinted with part number and date code for quick identification.**
- **ALL cylinders are factory pressure and leak tested prior to shipping.**



Part No. 100122

Air Cylinder - 2-1/2" I.D. x 4" Stroke. Cylinder Type: Push / Pull; Retracted Length: 9.37"

Part No. 100123

Air Cylinder - 2-1/2" I.D. x 6" Stroke. Cylinder Type: Push / Pull; Retracted Length: 11.37"

Part No. 100124

Air Cylinder - 2-1/2" I.D. x 8" Stroke. Cylinder Type: Push / Pull; Retracted Length: 13.37"

Part No. 100131

Air Cylinder - 3-1/2" I.D. x 6" Stroke. Cylinder Type: Push / Pull; Retracted Length: 13.60"

Part No. 100136

Air Cylinder - 3-1/2" I.D. x 8" Stroke. Cylinder Type: Push / Pull; Retracted Length: 18.35"

Part No. 100137

Air Cylinder - 3-1/2" I.D. x 8" Stroke. Cylinder Type: Push / Pull; Retracted Length: 15.60"



ABS TECH INFO - ARVIN MERITOR

End of Line Testing without TOOLBOX™ Software

**(Using the ABS lamp
to check the line.)**

1. Apply 12 volts DC power to the ABS.
2. The ECU/single modulator valve assembly should click two times.
3. If the indicator lamp comes on for three seconds and goes out: This indicates a correct installation. The end of line test is complete. If the ABS indicator lamp comes on and stays on, check the sensor installation:
 - A. Remove the power from the ABS and raise the sensed wheels so they may be rotated.
 - B. Repeat Step 1 and Step 2.
 - C. Rotate each sensed wheel — one at a time — at a rate of 1/2 revolution per second. This rate equals a wheel speed of approximately 4 mph (7 kph). The ABS indicator lamp should now go out and stay out indicating a correct installation. The end of line test is complete.
4. If the ABS lamp does not go out, there is a sensor gap problem or hardware fault. Adjust the sensor and, if necessary, perform a fault code check.

Sensor Gap Adjustment

Push the sensor into its holder until it contacts the tooth wheel. At installation, there must be no gap between the sensor and the tooth wheel. Measure the AC voltage output. The value should be 0.2 volt AC when the wheel is rotated at a rate of 1/2 revolution per second. Perform any necessary repairs. Repeat the sensor installation check. If the trailer lamp still does not go out, a system fault exists. Perform a fault code check.

Fault Code Check

MERITOR WABCO

Use constant power activation to perform the following fault code check.

1. Apply constant power to the ECU/single modulator valve assembly for more than one, but less than five seconds.
2. Remove the power.
3. Reapply the power.
4. Check the trailer ABS indicator lamp on the side of the trailer. The fault code will be displayed three times.
5. Find the fault on the chart and perform the necessary repairs.
6. After performing the necessary repairs, repeat the end of line test to verify correct sensor installation.

Blink Code Chart (Most common codes - for more info see Meritor Wabco TP-0173 chart)

<u>Blink Code</u>	<u>Problem Area</u>	<u>Action</u>
4	Sensor YE1 (curbside sensor)	Check sensor installation. Perform necessary repairs.
6	Sensor YE2 (roadside sensor)	Check sensor installation. Perform necessary repairs.
7	ECU/single modulator valve assembly	Verify correct installation. If code continues, contact Meritor WABCO for assistance.
14	Power Supply	Verify correct electrical installation. Check power supply. Perform necessary repairs.
15	ECU Failure	Verify correct installation. If code continues, contact Meritor WABCO for assistance.
16	SAE J1708 Failure	Internal failure, contact Meritor WABCO.
17	SAE J2497 Failure	Internal failure, contact Meritor WABCO.
18	Generic I/O Failure	Verify correct electrical installation. Check power supply. Perform necessary repairs.



OEM ONLY - ABS 2S/1M, 2S/2M MERITOR WABCO COMPONENT KITS

2 Sensor/1 Modulator Valve
(2S/1M) Configuration Shown
Tandem Suspension,
Two Wheels Sensed

2 Sensor/1 Modulator Valve
(2S/1M) Configuration Shown
Tandem Suspension,
Two Wheels Sensed

MERITOR WABCO

KIT PART NO. 1542014

KIT PART NO. 1542015

Enhanced Easy-Stop™

REPLACEMENT PARTS LIST		
Qty	Part No.	Description
1	S4005001010	ECU
1	S4493260300	10' Power cable
2	S4497130180	6' Sensor Ext cable
1	---	Installation Guide
1	---	End of Line Test

REPLACEMENT PARTS LIST FOR		
Qty	Part No.	Description
1	S4005001010	ECU
1	PEC4-48	48' Power Ext cable
1	S4493260050	1.6' Power Cable
2	S4497130180	6' Sensor Ext.cable
1	---	ABS Label For Lamp
1	---	Installation Guide
1	---	End of Line Test

MERITOR WABCO

We have developed these kits for MANUFACTURERS ONLY - OEM ONLY.
These kits are not available to aftermarket distributors -
Those kits are on the following pages. THANK YOU!

2S/1M schematic (showing air)

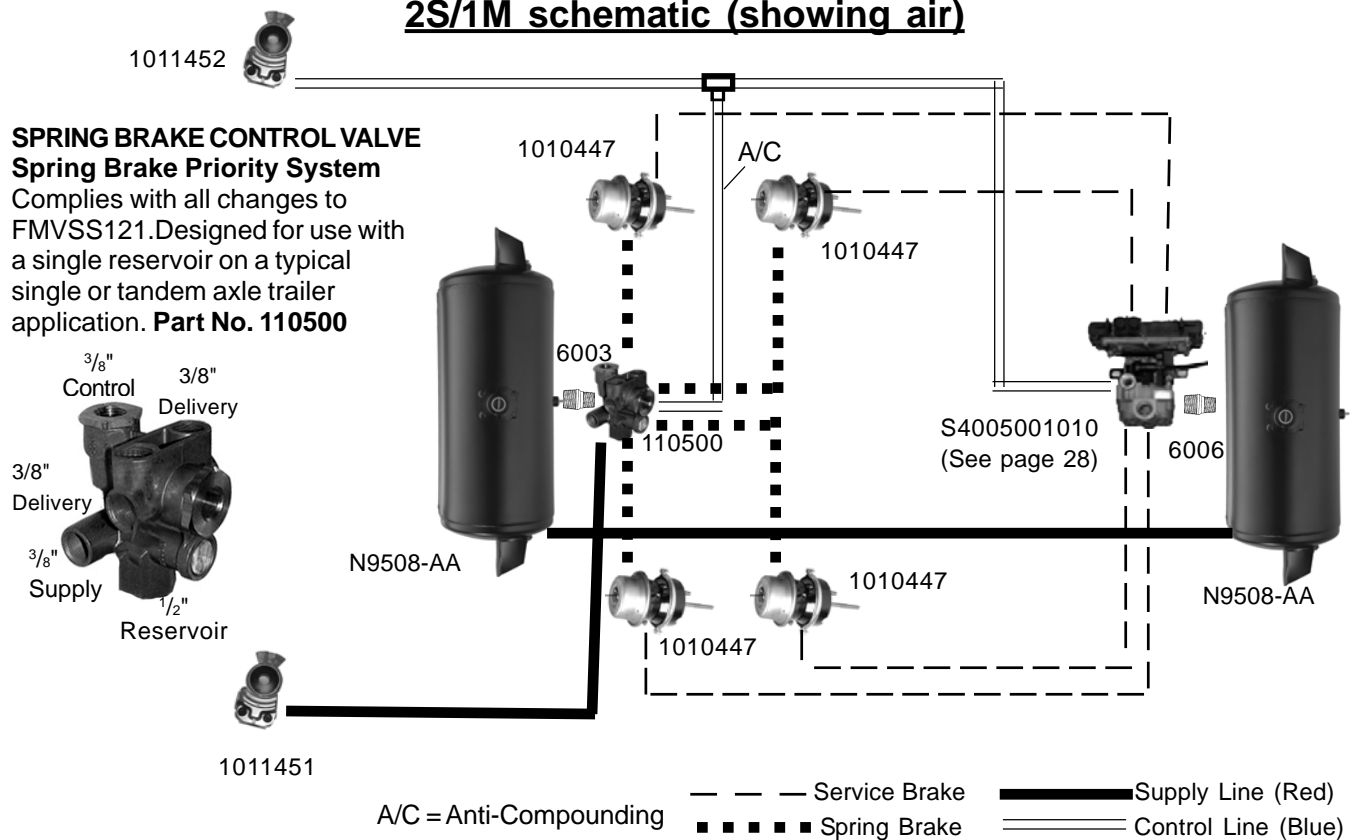

110500 - Spring Brake control valve, **R955322** - Wabco ECU valve, **6003** - 3/4" to 1/2" pipe nipple, **6006** - 3/4" pipe nipple, **N9508-AA** air tank, **1010447** - spring brake chamber, **1011451** - red emergency gladhand, **1011452** blue service gladhand.



ABS - 2S/1M COMPONENT PARTS - SPRING BRAKE PRIORITY

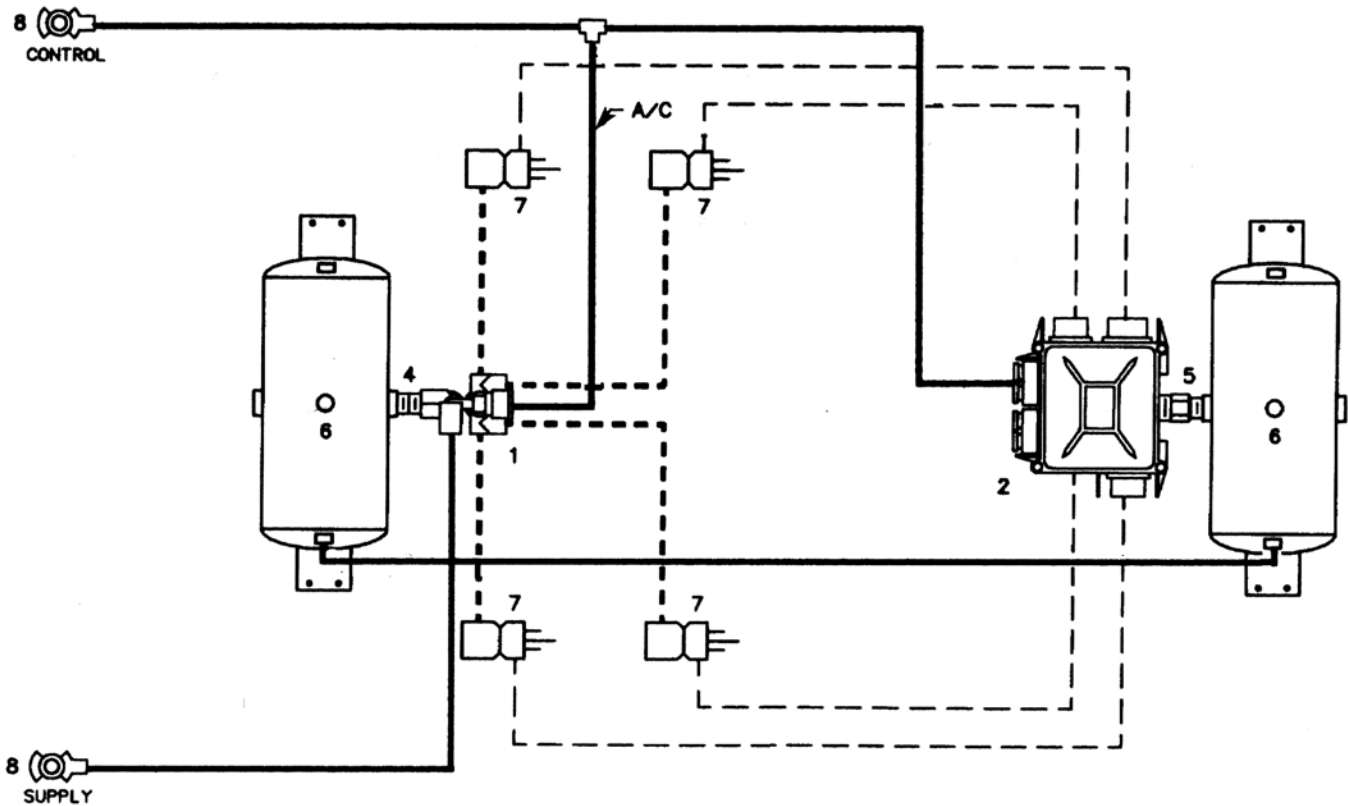

A/C = Anti-Compounding - - - Service Brake ——— Supply Line (Red)
 Spring Brake ——— Control Line (Blue)

COMPONENTS LISTING: Typical Set Up Guide:

No. 1 = 110500 - Spring Brake control valve,

No. 2 = S4005001010 - Wabco ECU valve,

No. 4 = 6003 - 3/4" to 1/2" pipe nipple,

No. 5 = 6006 - 3/4" pipe nipple,

No. 6 = N9508-AA air tank,

No. 7 = 1010447 - spring brake chamber,

No. 8 = 1011451 - red emergency gladhand,

No. 8 = 1011452 blue service gladhand.

MERITOR WABCO



ABS - 4S/2M MERITOR WABCO COMPONENT KITS

We have developed these kits for **MANUFACTURERS ONLY - OEM ONLY.**
These kits are not available to aftermarket distributors
- Those kits are on the following pages.
THANK YOU!

4 Sensor/2 Modulator Valve (4S/2M) Configuration Shown
Suggested Electrical Diagram
Tandem Suspension,
Four Wheels Sensed

SPRING BRAKE CONTROL VALVE Spring Brake Priority System

Complies with all changes to FMVSS121.
Designed for use with a single reservoir on a typical single or tandem axle trailer application.

Part No. 110500



KIT PART NO. 1544223

REPLACEMENT PARTS LIST		
Qty	Part No.	Description
1	S4005001030	ECU
1	S4493260300	10' Power Cable
2	S4497130300	10' Sensor Ext cable
2	S4497130180	6' Sensor Ext cable
1	---	ABS Label For Lamp
1	---	Installation Guide
1	---	End of Line Test

MERITOR WABCO

Enhanced Easy-Stop™

ABS Power Extension Cable - 48 ft.

ISO connector one end, blunt cut on the other, with a connector wire to the ABS warning lamp.

Part No. PECW-48



4S/2M schematic (showing air)

- 110500** - Spring Brake control valve,
- S4005001030** - Wabco ECU valve,
- 6003** - 3/4" x 1/2" hex nipple
- 6006** - 3/4" pipe nipple,
- 1010329** air tank,
- 1010447** - spring brake chamber,
- 1011451** - red emer. gladhand,
- 1011452** blue svc. gladhand.

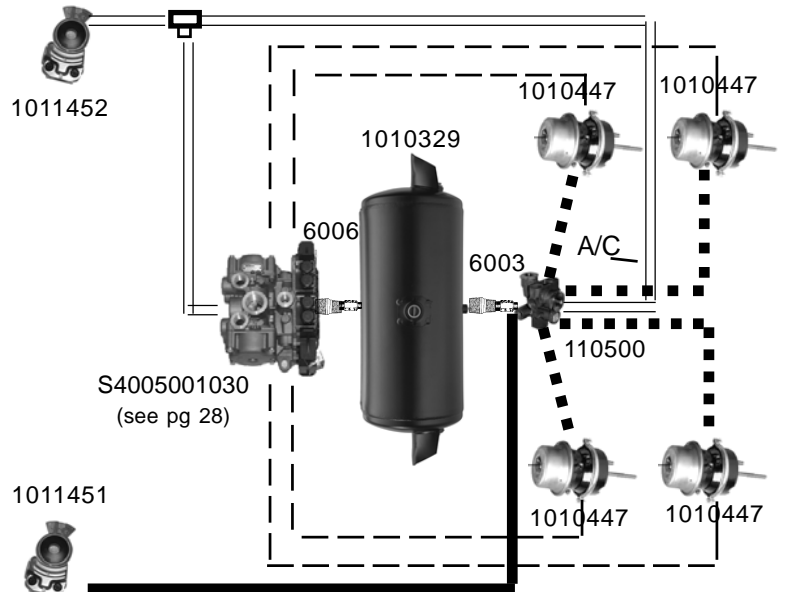

A/C = Anti-Compounding

Service Brake
 Supply Line (Red)

Spring Brake
 Control Line (Blue)



MERITOR WABCO ABS ENHANCED EASYSTOP™ CONVERSION KITS

Meritor WABCO has created a series of retrofit kits to replace the previous Easy-Stop platform, to the current production Enhanced Easy-Stop platform.

Easy Stop was installed on production built trailers between March 1997 and February 2001.

Enhanced Easy-Stop incorporated current technology to address regulatory PLC requirements and has been installed from March 2001 to present.

MERITOR WABCO

To determine the proper kit, find the existing Easy-Stop ECU/Valve part number that needs to be replaced.

Then determine if you will pull the diagnostics from the **tractor** (power adapter equipped kits) or from the **trailer** (power adapter with diagnostic adapter equipped kits).

Converting Meritor WABCO Easy Stop to Enhanced Easy-Stop™ Trailer ABS ECU/VALVE

<u>Easy Stop</u> <u>ECU/Valve#</u>	<u>Description</u>	<u>Enhanced Easy Stop</u> <u>Power AdapterRetrofit Kit</u>	<u>Enhanced Easy Stop</u> <u>Power/Diagnostic Adapter Retrofit Kit</u>
472 500 021 0	2S/1M for Trailers	R955344	R955345
472 500 011 0	2S/1M for Dollies	R955322	R955323
472 500 012 0*	2S/1M, 2S/2M, 4S/2M	R955320	R955321
472 500 013 0	4S/3M	R955346	R955347

•If a 472 500 012 0 ECU/Valve was used in an Easy Stop 2S/1M application, order a R955344 or R955345 kit. Kits contain an Enhanced Easy-Stop ECU/Valve and either a power cable adapter or power/diagnostic cable adapter.

Part No. R955344
(from the tractor)

For Trailer Applications Only
(NO Dolly) 2S/1M

Replaces Meritor
Part Number 4725000210
w/S8946073120 cable



Part No. R955345
(from the trailer)

For Trailer Applications Only
(NO Dolly) 2S/1M

Replaces Meritor
Part Number 4725000210
w/S8946073130 cable



Part No. R955322
(from the tractor)

For Dollies Only 2S/1M

Replaces Meritor
Part Number 4725000110
w/S8946073120 cable



Part No. R955323
(from the trailer)

For Dollies Only 2S/1M

Replaces Meritor
Part Number 4725000110
w/S8946073130 cable



Part No. R955320
(from the tractor)

2S/1M, 2S/2M, 4S/2M

Replaces Meritor
Part Number 4725000120
w/S8946073120 cable



Part No. R955321
(from the trailer)

2S/1M, 2S/2M, 4S/2M

Replaces Meritor
Part Number 4725000120
w/S8946073130 cable



**MERITOR WABCO ENHANCED EASYSTOP™ COMPONENTS****Part No. S4005001010**

ECU Valve Assembly
2S/1M Basic for trailer
(after the 3/1/01 date)

**Part No. S4461082010**
ECU Only**Part No. S4005001020**

ECU Valve Assembly
2S/2M Basic for trailer
(after the 3/1/01 date)

Part No. S4721950330

Relay Valve with boyonet
connector. Valve replacement
for S4005001010.
(after the 3/1/01 date)

**Part No. S4005001030**

ECU Valve Assembly
4S/2M Basic for trailer
(after the 3/1/01 date)

**Part No. S4008506010**
ECU Only**Part No. S4008500530**

Modulator Valve, 1/2" ports.
Kostal Connector, 12 V

**Part No. S4008500540**

Modulator Valve, 1/2" ports.
Bayonet Connector, 12 V

**Part No. S4493260100**

ABS Power Cable
4 conductor, 3.3 feet.
for standard harness connector

**Part No. S4493260050** - 1.65 feet.**Part No. S4493260300** - 10 feet. (shown)**Part No. S4493260470** - 15.4 feet.**Part No. S8946073120**

Adapter cable. Connects Easystop
power cable to enhanced Easystop
ECU/Valve assembly.

**Part No. S8946073130**

Adapter cable with diagnostic cable.
Connects Easystop power cable to enhanced
Easystop ECU/Valve assembly.

**Part No. S8946062752**

ABS connector relay
2S/1M Basic.

**Easy Stop**
Power Cables**Part No. S8946049440**

Power cable, 4 conductor, 3', std connector

Part No. S8946049450

Power cable, 4 conductor, 13', std connector

Part No. S8946060380

Power cable, 4 conductor, 14', std connector

Part No. S8946060500

Power cable, 4 conductor, 20', std connector

**Part No. S4493641500**

13.1' / 9.8' Power "Y" Cable

Part No. S4493641530

20' / 10' Power "Y" Cable3

**NOTE: Sensors and Sensor Extensions are Universal to Both Systems**



MBS ABS KIT - FLEETCRAFT

Wabash National announced that it has discontinued its proprietary ABS products for all production trailers, and we have the complete replacement retrofit kits available for slider suspensions.

Part Number 1532014

2S/1M ABS Kit: **INCLUDES:**

PLC Select Valve/ECU Assembly - 6 port
Power Cord Extension
2 Sensor Clips
Heavy Duty Hex Nipple
Installation Instructions
PLC Service Manual



The 1532014 kit has no sensors so that the existing sensors can be used if the existing sensor numbers are 10800126 (Wabash number), or S4410328080 (Meritor number.)



MBS ABS KITS - MERITOR

Wabash National announced that it has discontinued its proprietary ABS products for all production trailers, and we have the complete replacement retrofit kits available for slider suspensions.

Part Number R955382

2S/1M ABS Kit: **INCLUDES:**

ECU Valve Assembly.
Power cable 14 ft with iso plug,
sensor extension cables (2) 6 ft w/ plug,
sensor springs (2), installation instructions.



The R955382 kit has no sensors so that the existing sensors can be used if the existing sensor numbers are 10800126 (Wabash number), or S4410328080 (Meritor number.)

Also available - R955383 for 4S/2M.

KITS ARE BOXED / 1 BOX PER TRAILER.

MBS ABS KITS!

Part Number R955374

2S/1M ABS Kit: **INCLUDES:**

ECU Valve Assembly.
Sensors (2) 1 ft,
power cable 14 ft w/iso plug,
sensor extension cables (2) 6 ft w/ plug,
sensor springs (2), installation instructions.



The R955374 includes sensors if the existing sensors are not Meritor, or all new sensors are needed.

Also available - R955375 for 4S/2M.

MERITOR WABCO



MISCELLANEOUS MERITOR WABCO ABS COMPONENTS

Sensor Placement

When more than one wheel is controlled by a single valve, sensors should be mounted at the axle which tends to lock first. For spring suspensions this is usually the forward axle. For air suspensions this is usually the rear most axle.



1810000
1810002
1810003

1810001

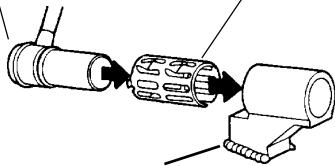

Sensor Holder
Part No. S2255U1113
(welded to axle spindle)

Common ABS Components	
Part No.	Description
1810000	Bendix /Haldex 1' Sensor
1810001	Friction Bushing / Clip
1810002	Meritor Wabco 1' Sensor
1810003	Meritor Wabco 3' Sensor

S8997605104 Stainless steel friction busing clip



POWER CABLES

Part No. Description (EZ STOP)

- S8946049440** ABS Power Cable, 3 feet, with industry standard plug.
- S8946049450** ABS Power Cable, 13 feet, with industry standard plug.
- S8946060380** ABS Power Cable, 14 feet, with industry standard plug.
- S8946060500** ABS Power Cable, 20 feet, with industry standard plug.

Right Angle (90°) Sensor Kits

Includes sensor, bushing clip, friction lube, and instructions.

Part No.	Cable lead in Feet
R955335	1.0
R955336	3.0
R955341	5.8
R955342	6.6



MERITOR WABCO

Straight Sensor Kits

Includes sensor, bushing clip, friction lube, and instructions.

Part No.	Cable lead in Feet
R955329	5'6"
R955337	5'8" (Sensor is 65mm)
R955338	5'8" (Sensor is 79mm)



Sensor Extension Cables

Part No.	Cable Feet
S4497130180	6 feet
S4497130300	10 feet
S4497130500	16 feet



ABS Power Cable

4 Cond., 49 feet, w/blunt cut end.

Part No. S4493151500



ABS Diagnostic (Pre-PLC)

Cable with Tool

Part No. SA13237L1130



ABS Relay Valve

Second modulator valve for use on 2S/2M and 4S/2M Systems

Part No. R955378



ABS Relay Valve

with bayonet connector. Valve replacement for S4005001010

Part No. S4721950330



ABS Modulator Valve

Controls air pressure to the brake chambers during an ABS stop.

Part No. S4008500530

12 volt, kostal style connector. (screw-on)



Part No. S4008500540

12 volt, bayonet style connector.





ABS ELECTRIC CONFIGURATION - 2S/1M - HALDEX PLC - FULL FUNCTION

Kit Part No. AQ961404

PARTS LIST Consisting of:		
Qty	Part No.	Description
1	AL919310	ECU
1	AL430624	Full Function ABS Valve
2	AL919804	7.5' Sensor Cable Ext
1	AL919901	12' Power Cord Ext
1 box	-	Tie Down Clips



- PLC Select ECU Design
- FFABS Relay Valve
- 3/4" nipple, spring brake priority.
- For Van Trailers
- Complies with the March 2001 PLC4 Trucks industry.
- Kit includes detailed instructions for installation and maintenance.

Kit Part No. AQ960802

PARTS LIST Consisting of:		
Qty	Part No.	Description
1	AL919310	ECU
1	AL430624	Full Function ABS Valve
2	AL919804	7.5' Sensor Cable Ext
1	AL918602	62' Power Cord, 38' drop
1 box	-	Tie Down Clips



- PLC Select ECU Design
- FFABS Valve Type
- Reservoir Mount
- Control Port (1) 3/8"-18
- Emergency Supply Port (1)3/8"-18
- Complies with the March 2001 PLC4 Trucks industry.
- Kit includes detailed instructions for installation and maintenance.



ECU
Part No. AL919310

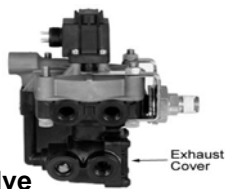

FF ABS Valve
Part No.AL430624



Power Cord
Part No. AL918602



Sensor Cable extension
Part No. AL919804

ABS AIR CONFIGURATION - UNIVERSAL PLC 2S/1M REPLACEMENT KIT

AQ960510 Universal PLC Select ABS Kit will replace all competitive brands and generations of trailer 2S/1M (2 Sensor - One Modulator Valve) ABS systems. These are any systems that utilize a single ABS valve, two sensors, and a separate spring brake control valve. Some additional components unique to the vehicle being upgraded should be expected. Do not use this kit to replace the Haldex FFABS ABS System as this is a single valve per vehicle and spring brake control is integral to the FFABS valve.

Kit Part No. AQ960510

PARTS LIST Consisting of:	
Qty	Description
1	PLC Select Valve ECU Assy. 6 Port
1	19 Foot Power Cord Ext.
2	6.6 foot Sensor Extensions
1	Installation Instructions L31203
1	PLC Service Manual L30030





ABS PLC SELECT UPGRADE KIT - 2S / 1M

Wheel-speed Sensor and Trailer Power connects directly to ECU - no intermediate cables required.

Single fastener design assures easy serviceability.

Potted ECU Enclosure provides excellent protection from the environment.



Part No. AQ964110

KIT CONTAINS:

- 1M Power Cord Extension
- 0.5M Sensor Extensions
- PLC Select ECU & Bracket.



**ECU Valve
PLC Select
Part No.
AL919338**



- Meets FMVSS121 requirements including March 2001 In-Cab Malfunction Lamp.
- Embraces "Power Line Carrier" multiplexing technology.
- Standard Electronic Odometer.
- Select Low-High software is standard.
- Sensor and Power Connectors plug directly into the ECU.
- Potted ECU Enclosure
- New Mounting Bracket with single fastener design.
- Standard on-board diagnostic capability
- Compatible with both PLC InfoCenter and PLC PC.

ABS ELECTRICAL CONFIGURATION - 4S/2M - FULL FUNCTION



**ECU
Part No. AL919311**

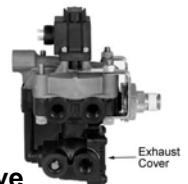

**FF ABS Valve
Part No. AL430624**

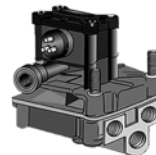

**Modulator Valve
Part No. AL364041**



**Sensor Cable extension
Part No. AL919804**



Kit Part No. AQ963011

PARTS LIST Consisting of:		
Qty	Part No.	Description
1	AL919311	ECU
1	AL430624	Full Function ABS Valve
2	AL919802	4.5' Sensor Cable Ext.
2	AL919804	7.5' Sensor Cable Ext.
1	AL919901	12' Power Cord Ext.
1	AL364040	Modulator Valve
1	AL40906	Loom Assembly
1 box	-	Tie Down Clips



HALDEX ABS COMPONENTS

ABS Modular Valve less ECU

Part No. AL364040

Single axle application



Number of Ports: **2**
 Mounting Port Size: **1/2 inch**
 Delivery Port Size: **3/8 inch**
 Mount: **Reservoir**
 Application: **24mm 12 volt Solenoid.**

ABS Modular Valve less ECU

Part No. AL364041

Multi-axle application.

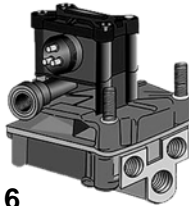

Number of Ports: **6**
 Mounting Port Size: **1/2 inch**
 Delivery Port Size: **3/8 inch**
 Mount: **Reservoir**
 Application: **24mm**

12 volt Solenoid

Electronic Control Unit (ECU)

Part No. AL919302

No longer available.

Use AQ964110 upgrade kit
 MOD 1 - SLH-A5-19 Pin

- OEM part no. is located on top.
- Post mandate ECU's include bail latch.



Pin Housing Dimensions:

3-1/2 inch Height x 5-3/8 inch Wide

Application/Notes: Pre-March '01

FFABS Valve

With integral spring brake control. Pre-installed reservoir nipple with swivel and locknut feature. Comes standard with filters in both the control and supply ports.

Part No. AL430611 **Description**
 4 port, 1/2" nipple, 12 volt, 3/8" ports.

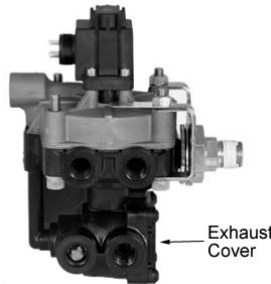

Exhaust Cover

- ECU & bracket may need to be transferred from existing valve.
- Use inlet filter A906960 in off-highway applications.

FFABS Valve

Part No. AL430614 **Description**
 4 port, 3/4" nipple, 12 volt, 3/8" ports

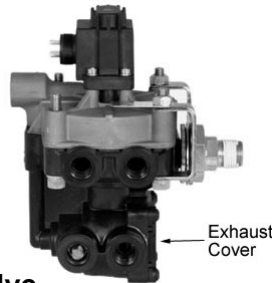

Exhaust Cover

With integral spring brake control. Pre-installed reservoir nipple with swivel and locknut feature. Comes standard with filters in both the control and supply ports.

- ECU & bracket may need to be transferred from existing valve.
- Use inlet filter A906960 in off-highway applications.

ABS Power Cable

ECU end includes industry standard 5-pin female connector. 7-way end is stripped wires. For production Mar. '01-present.

Part No. AL918603 **Length**
 38 feet
 ABS lamp lead is 25 feet.

AL918604 52.5 feet
 ABS lamp lead is 26.2 feet.

AL918606 15 feet
 ABS lamp lead is 4 feet.



Power cord repair kit

5 way terminal kit for power cords.

Part No. AQ15473



Right Angle (90°) Sensor Kit

Includes sensor, bushing clip.

Part No. AL10271914 **Cable lead**
 1.6 feet





BENDIX ABS COMPONENTS

Bendix® TABS-6 (Standard)
Trailer Antilock Braking System
Few connections, small and light, fast and reliable, for all applications.

Part No.801855

2S/1M trailer ABS module.
Communicates over PLC.
Has a 4 port relay.



MC-12 Trailer ABS Modules - Replacement Kit

Part No.802902

The MC-12 trailer ABS modules are no longer available. TABS-6 kits are available for service. 19.5 foot cable, 5-pin ABS pigtail and sensors.

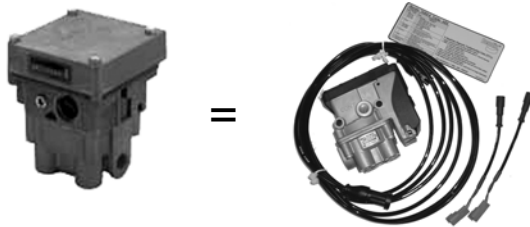

A-18 Trailer ABS Modules - Replacement Kit

Part No. K019711

The A-18 trailer ABS modules are no longer available. TABS-6 kits are available for service.



ABS Diagnostic Tools

Part No.	Description
801869	RDU - Remote Diagnostic Unit
801872	RDU adapter - 6 pin to 9 pin adapter cable
802229	RDU adapter - 9 pin to 9 pin adapter cable
802435	RDU plus 6 pin to 9 pin adapter cable
802436	RDU plus 9 pin to 9 pin adapter cable
802162	TRDU - Trailer Remote Diagnostic Unit
802165	TRDU adapter - 7 pin connector for TRDU



801869
Tractor
RDU



801872
RDU
Adapter



802229
TRDU
Adapter



802162
Trailer
TRDU



802165
TRDU
Adapter



Bendix EC-30™
Electronic Controller -ECU
Part No. 801236

6S/4M -sensors and modulators.
Traction control.
EC-16™ and EC-17™ service replacement.



Bendix MC-30™ trailer ABS module
Part No.800737

Tank mounting. Default config is 4S/2M side, will auto configure to 2S/2M axle, 2S/1M.

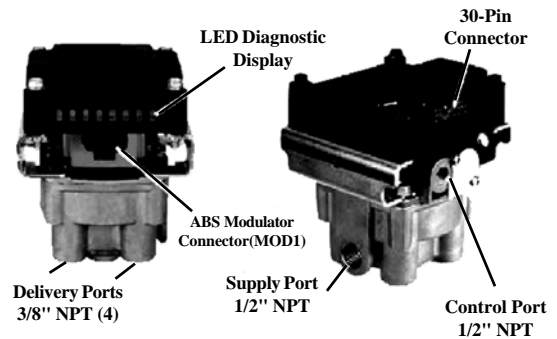

Bendix Pressure Modulator Valves

Part No.	System
801481	12 volt, M-32QR™
801666	12 volt, M-32™

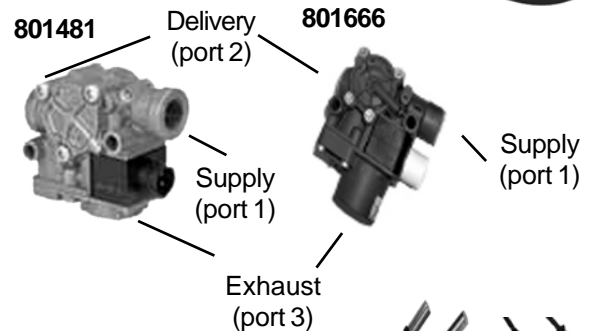

WS-24™ Wheel Speed Sensors

Part No.	Description
801546	90°, 60", w/Deutsch connector.
801552	Straight, 75" w/DT04 connector.

801534 Clamping Sleeve
The WS-24™ is compatible with all previous Bendix sensors if used with this clamping sleeve.

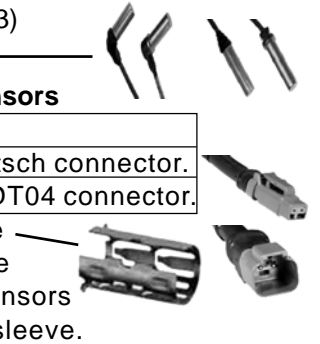

Power Cord
MC-30™ cable assembly
Part No. 801697

